

TRAFFIC ANNOUNCEMENT
LONG-TERM NIGHT CLOSURE AT SLIP ROAD TOWARDS BUKIT JALIL HIGHWAY
BUKIT JALIL HIGHWAY
19/11/2017

Date	21 November 2017 - 31 December 2017
Time	10.00PM - 6.00AM
Duration	41 days
Reason	To facilitate traffic diversion, premix work, road line marking, installation of street lighting and guardrail, utilities relocation and pile cap for MRT construction works

There will be a long-term night closure at the KM7.2 slip road from Kuala Lumpur heading towards Bukit Jalil highway **from 21 November 2017 – 31 December 2017**, 10:00pm to 6:00am, intermittently.

During this period, one lane will be made available for motorists from Kuala Lumpur heading to Bukit Jalil (indicated in **BLUE** arrows in map). Flagmen will be stationed to direct motorists heading to Bukit Jalil highway.

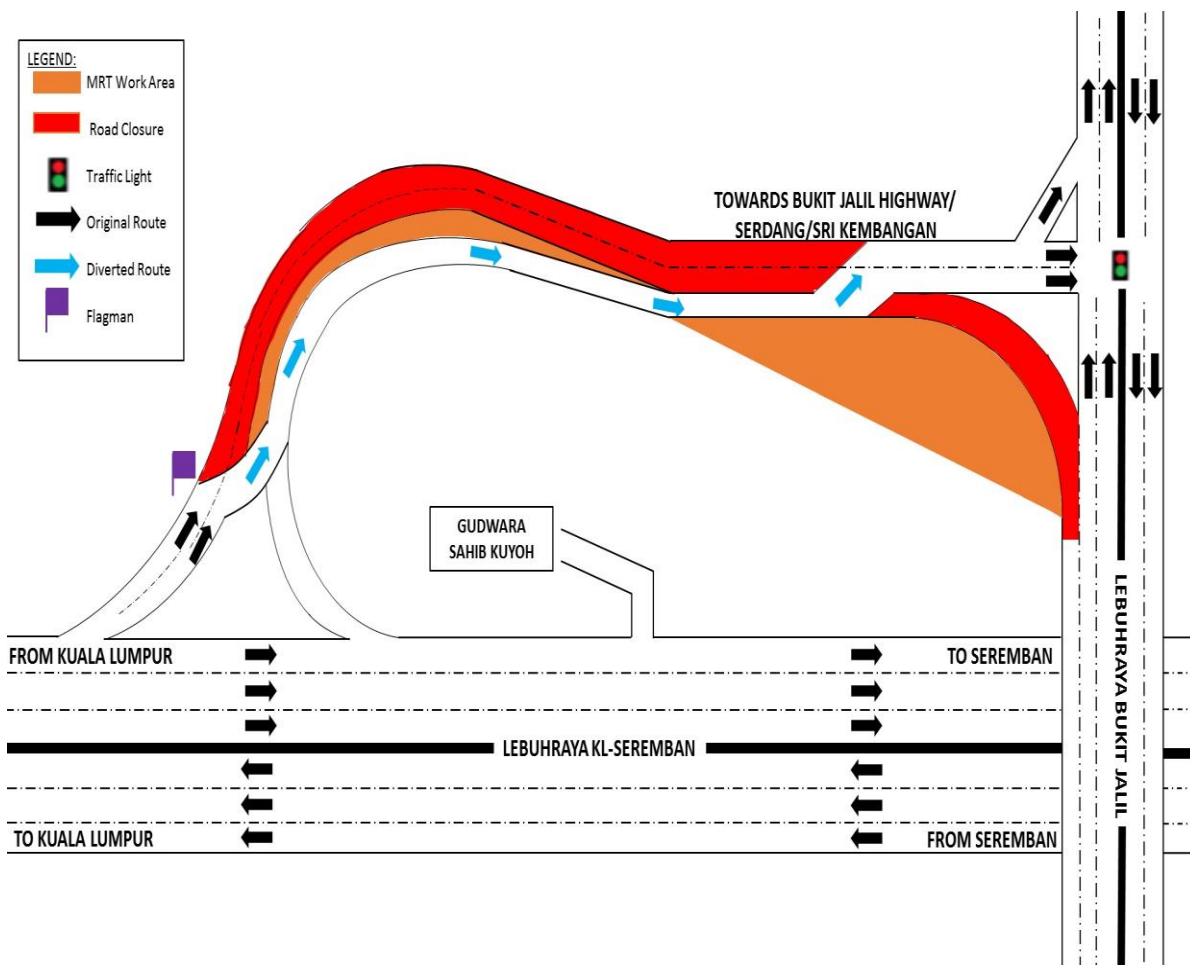

For media enquiries, please contact:

Mohd Sofie Hasan

Tel: +6019 228 3004

sofie@sunway.com.my

Leanne Susau

Tel: +603 7493 3832

leanne@mgjv-kvmrt.com.my

MMC GAMUDA KVMRT (PDP SSP) SDN BHD (1117100-V)

Block A, Level 17, Menara Mustapha Kamal, PJ Trade Centre

No 8, Jalan PJU 8/8A, Bandar Damansara Perdana, 47820 Petaling Jaya

Selangor Darul Ehsan, Malaysia

T: +603-7494 2222 F: +603-7727 0222 <http://www.mymrt.com.my>