

**TRAFFIC ANNOUNCEMENT**  
**INTERMITTENT LANE CLOSURE AT JALAN PUTRA PERMAI (PUCHONG AND SERDANG - BOUND)**  
**JALAN PUTRA PERMAI**  
**31/10/2017**

Date	02 November 2017 - 16 November 2017
Time	24 HOURS
Duration	15 DAYS
Reason	To facilitate site Mapping and Piloting, Soil Investigation, Survey, Utilities Relocation and any related works.

There will be 200-meter intermittent lane closure on the right-most lane along Jalan Putra Permai (Puchong and Serdang-bound) from **2 November 2017 until 16 November 2017**. During the closure, one lane will be made available for motorist on both bounds.

The closure will be done in stages as follows (please refer to map):

**Jalan Putra Permai heading towards Serdang**

**S1** - During the lane closure, the left-most lane will be made available for motorist from Jalan Putra Permai heading towards Serdang.

**S2** - During the lane closure, the right-most lane will be made available for motorist from Jalan Putra Permai heading towards Serdang.

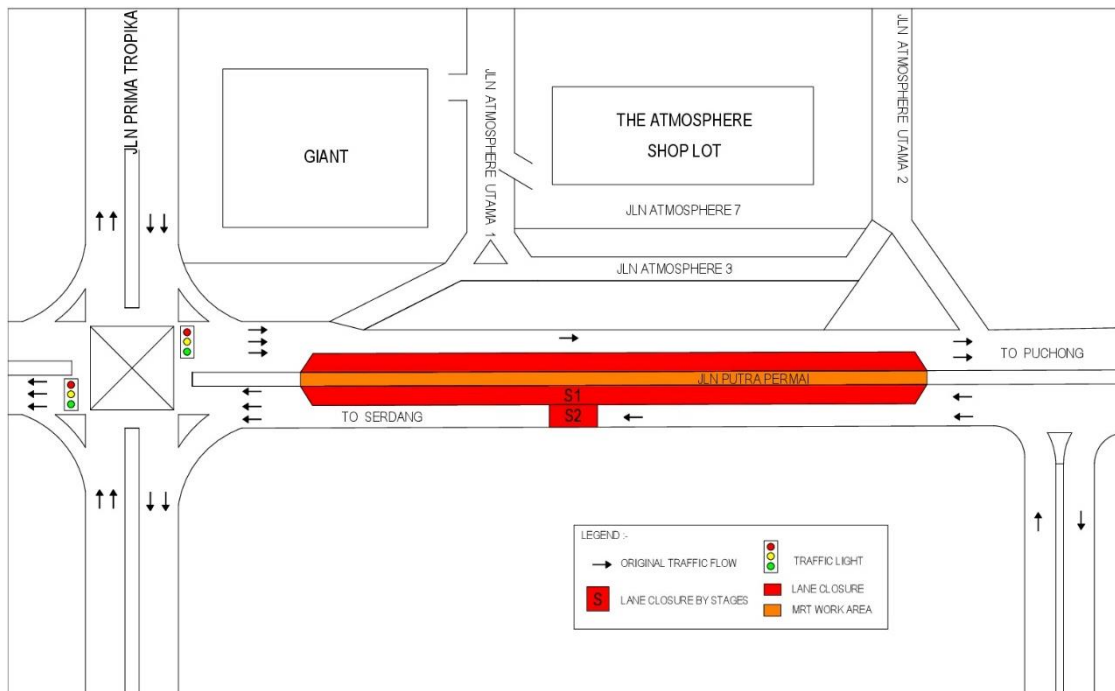

For media enquiries, please contact:

Mohd Lotfi Abdul Latiff

Tel: +6012 2100 766

[Mlotfi@V208.com.my](mailto:Mlotfi@V208.com.my)

Leanne Ann Susau

Tel: +603 7493 3832

[leanne@mgjv-kvmrt.com.my](mailto:leanne@mgjv-kvmrt.com.my)

**MMC GAMUDA KVMRT (PDP SSP) SDN BHD** (1117100-V)

Block A, Level 17, Menara Mustapha Kamal, PJ Trade Centre

No 8, Jalan PJU 8/8A, Bandar Damansara Perdana, 47820 Petaling Jaya

Selangor Darul Ehsan, Malaysia

T: +603-7494 2222 F: +603-7727 0222 <http://www.mymrt.com.my>