

TRAFFIC ANNOUNCEMENT
UPDATES ON TRAFFIC MANAGEMENT PLAN FOR MRT SSP CONSTRUCTION ALONG JALAN P9
AND PERSIMPANGAN PUTRAJAYA SENTRAL
11 OCTOBER 2017

1. CONTINUATION OF LONG-TERM LANE CLOSURE ALONG JALAN P9 TOWARDS PUTRAJAYA SENTRAL STATION (NORTH-BOUND)

Date	13 October 2017 – 09 October 2018
Time	24-hours
Duration	1 year
Reason	To facilitate site clearing, soil investigation, piloting, bore pile and pier construction for MRT Project

There will be a continuation of long-term full lane closure towards Putrajaya Sentral Station starting from **13 October 2017 to 09 October 2018, 24-hours**.

During this closure, motorists are advised to drop-off passengers at the covered walkway (as indicated in the map) and make the U-Turn at the new drop-off area to head back to Jalan P9 (North-bound). Meanwhile, motorists wanting to park their vehicles to ride the train can proceed to the replacement carpark area.

This full lane closure only will be implemented on the route towards Putrajaya Sentral Station. All other lanes along Jalan P9 will not be affected.

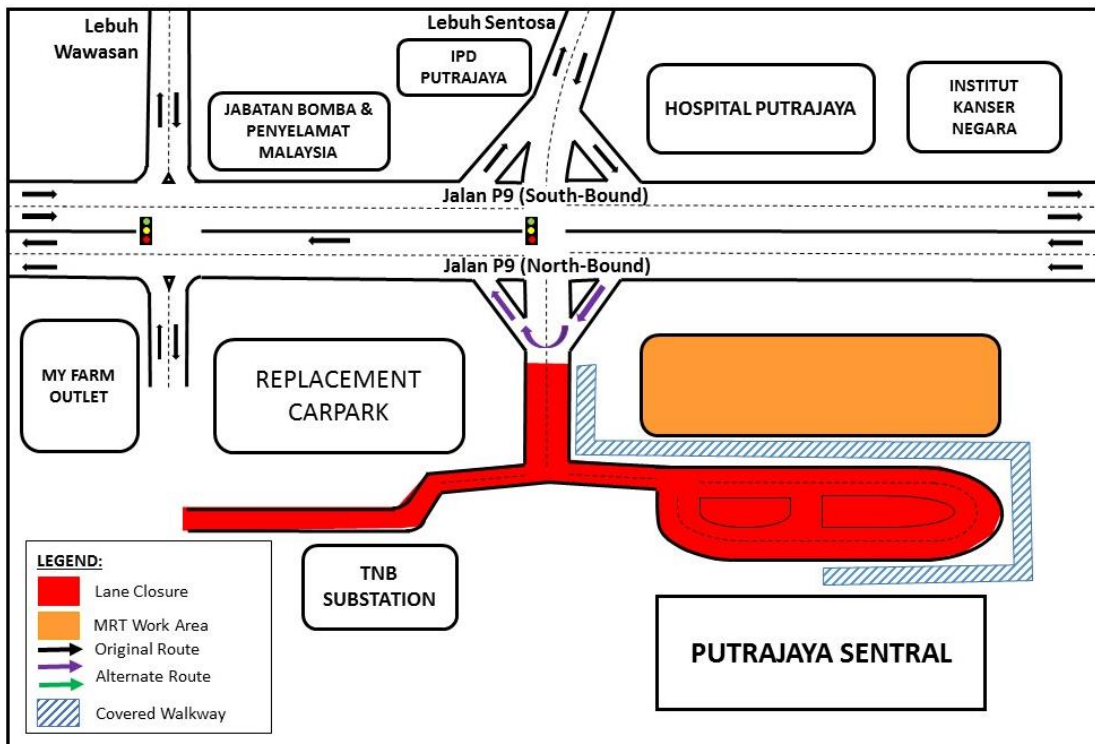

MAP 1 : CONTINUATION OF LONG-TERM LANE CLOSURE ALONG JALAN P9 TOWARDS PUTRAJAYA SENTRAL STATION (NORTH-BOUND)

2. CONTINUATION OF LONG-TERM LANE CLOSURES AT PERSIMPANGAN PUTRAJAYA SENTRAL

Date	13 October 2017 - 13 April 2018
Time	9:00am to 10:00pm & 24-hours
Duration	6 Months
Reason	To facilitate road widening, traffic diversion, piloting, installation of sheet pile, TNB & CCTV relocation for MRT construction work

There will be a continuation of long-term lane closures along Lebuhraya Pintasan Dengkil heading towards Persimpangan Putrajaya Sentral from **13 October 2017 to 13 April 2018**. The traffic management plan involves the following closure:

Closure A (24-hours): One lane closure for a stretch of 100 metres heading towards Taman DeCare, Putrajaya. Motorists from Presint 7 Putrajaya heading to Taman DeCare will be diverted to the opposite lane by flagman at both end using "STOP and GO" method of traffic flow (as indicated in **PURPLE** arrows in the map).

Closure B (24-hours):

- Slip road closure of the ramp going down to Taman DeCare Putrajaya. Motorists will be diverted to Taman DeCare exit to get to Presint 7 Putrajaya and Taman DeCare Putrajaya.
- Partial left lane closure of the ramp going down to Putrajaya Sentral.

Closure C (9am-10pm): Partial right lane closure of the ramp going down to Putrajaya Sentral.

Closure D (9am-10pm): Left lane closure heading to Putrajaya Sentral for a stretch of 100 metres. Motorists will be diverted to the right lane to get to Persimpangan Putrajaya Sentral.

Closure C and D will also be implemented intermittently from 10pm to 6am (night works) when required upon approval from the authority.

There will be flagmen to facilitate traffic flow as indicated in the map and at any one time there will be one (1) lane made available for motorists. All other lanes along Lebuhraya Pintasan Dengkil are not affected.

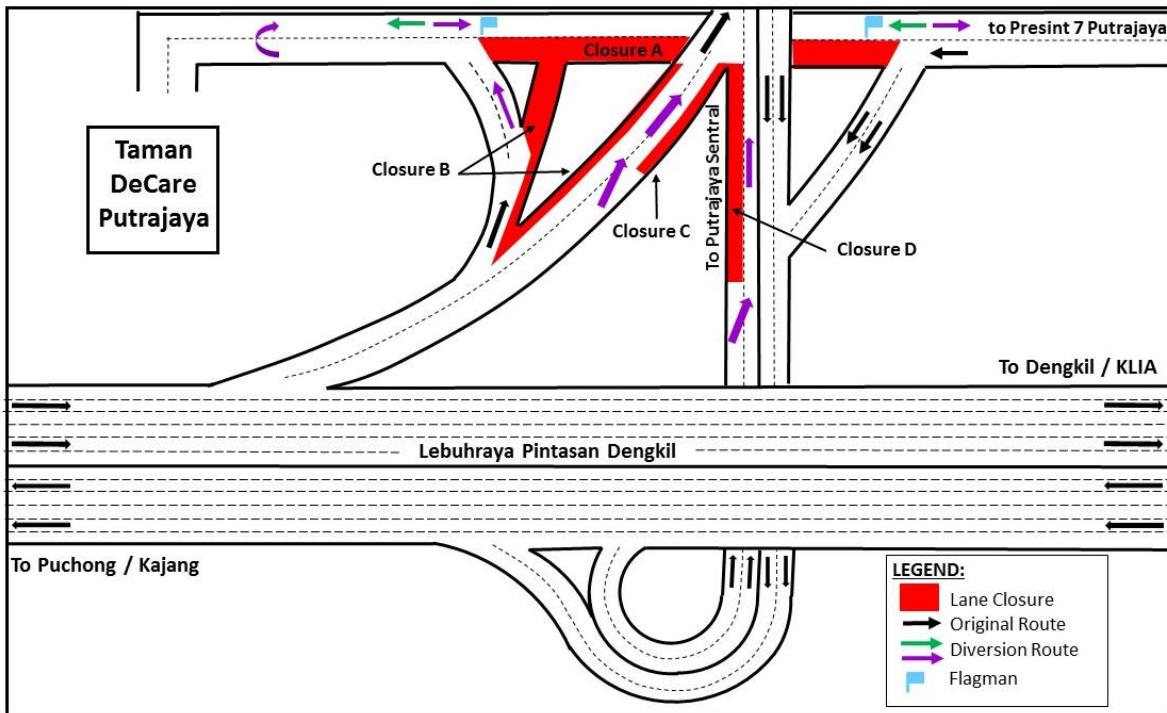

MAP 2 : CONTINUATION OF LONG-TERM LANE CLOSURES AT PERSIMPANGAN PUTRAJAYA SENTRAL

For media enquiries, please contact:

Mohd Hisham Abu Bakar
Leanne Ann Susau

Tel: +6017 447 2767
Tel: +603 7493 3832

hisham.bakar@mrcb.com
leanne@mgjv-kvmrt.com.my

MMC GAMUDA KVMRT (PDP SSP) SDN BHD (1117100-V)
Block A, Level 17, Menara Mustapha Kamal, PJ Trade Centre
No 8, Jalan PJU 8/8A, Bandar Damansara Perdana, 47820 Petaling Jaya
Selangor Darul Ehsan, Malaysia
T: +603-7494 2222 F: +603-7727 0222 www.kvmrt.com.my