

TRAFFIC ANNOUNCEMENT
UPDATES ON TRAFFIC MANAGEMENT PLAN FOR MRT CONSTRUCTION
AT SPRINT HIGHWAY, JALAN SEMANTAN AND LDP HIGHWAY
(5 August 2014)

1. TEMPORARY NIGHTLY CLOSURE AT SPRINT HIGHWAY BEFORE PETRONAS SECTION 16 (KL-BOUND)

Date	6 August 2014 - 15 September 2014
Time	11pm – 6am (Monday – Thursday, and Sunday) 12am – 7am (Friday and Saturday)
Duration	41 days
Reason	To facilitate launching gantry works for MRT construction.

There will be temporary nightly closure of three lanes (from left-most to the middle lanes) for a 800m stretch at SPRINT Highway (KL-bound) before Section 16 PETRONAS Petrol Station junction **effective 6 August 2014 to 15 September 2014. The closure will be at 11pm – 6am (Monday –Thursday and Sunday) and 12am – 7am (Friday and Saturday).**

During this closure, one lane (right-most lane) will be made available for motorists heading towards Kuala Lumpur.

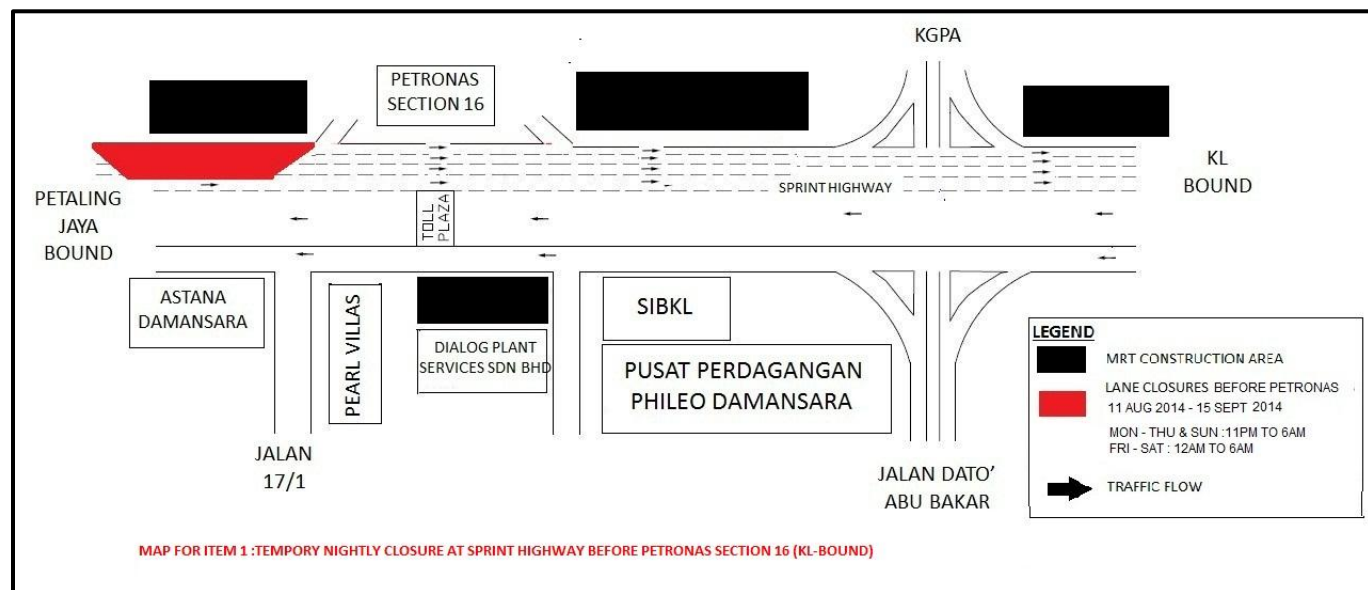

2. CONTINUATION OF FULL NIGHT CLOSURE OF SPRINT HIGHWAY/JALAN SEMANTAN

Date	To be continued until 30 September 2014
Time	<ul style="list-style-type: none"> • 11pm to 6am (Monday to Friday) • 12midnight (Saturday) to 12noon (Sunday)
Duration	2 months
Reason	Steel truss and launching work for Semantan MRT Station.

Full night closure of the SPRINT Highway/Jalan Semantan (both Kuala Lumpur and Petaling Jaya-bound) shall be continued until **30 September 2014. The closure will take place from 11pm to 6am (Monday – Friday) and 12midnight (Saturday) - 12noon (Sunday).** During the full closure, Jalan Dungun will be converted into a two-way traffic. Additional signages will be installed at Jalan Dungun to assist traffic flow. The closure will be done **intermittently** from 7.4KM until 8.1KM. *(Please see appended map).*

Motorists will be required to use the following alternative routes:

1. **Motorists from Kuala Lumpur heading to Petaling Jaya** on the SPRINT Highway/Jalan Semantan will be diverted up the ramp to Istana Pintu 2 into Lorong Dungun, straight to Jalan Gelenggang, and then turn left to Jalan Beringin towards underneath the flyover to join the SPRINT Highway.
2. **Motorists from Kuala Lumpur heading to Jalan Damansara, Jalan Jelutong and Jalan Damansara Endah** will also be diverted up the Istana Pintu 2 ramp, into Lorong Dungun, straight to Jalan Gelenggang, then left to Jalan Beringin towards underneath the flyover to join the SPRINT Highway, passing Pusat Bandar Damansara and up the ramp before connecting to Jalan Damansara, Jalan Jelutong and Jalan Damansara Endah.
3. **Motorists from Petaling Jaya heading to Kuala Lumpur / Jalan Dungun** will be diverted onto Jalan Beringin, right into Jalan Gelenggang, straight into Lorong Dungun, then right into Changkat Semantan before connecting back to the SPRINT Highway/Jalan Semantan.

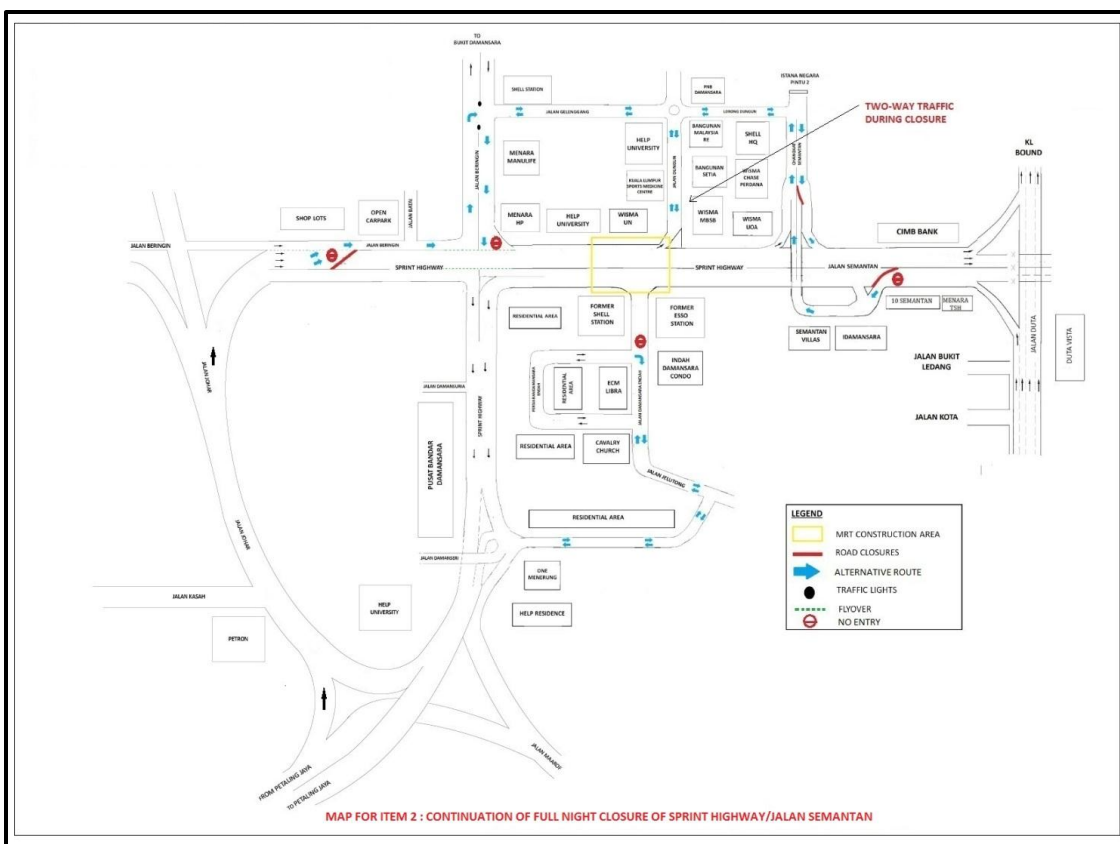

3. ONE NIGHT CONTRA-FLOW AT PERSIARAN SURIAN (SUNGAI BULOH-BOUND)

Date	8 August 2014
Time	12midnight to 5am
Duration	1 night
Reason	To facilitate relocation of launching gantry

Temporary night contra-flow traffic will be implemented for one (1) night at Persiaran Surian (Sungai Buloh-bound) from the junction of Jalan Camar (near Petronas/KFC) to the junction of Jalan Teknologi (near Petronas/Maybank) on 8 August 2014 from 12midnight - 5am.

Motorists from Sunway Giza, heading to Sungai Buloh will be diverted to the opposite lane. One traffic lane will be made available for each direction (LDP Highway and Sungai Buloh-bound).

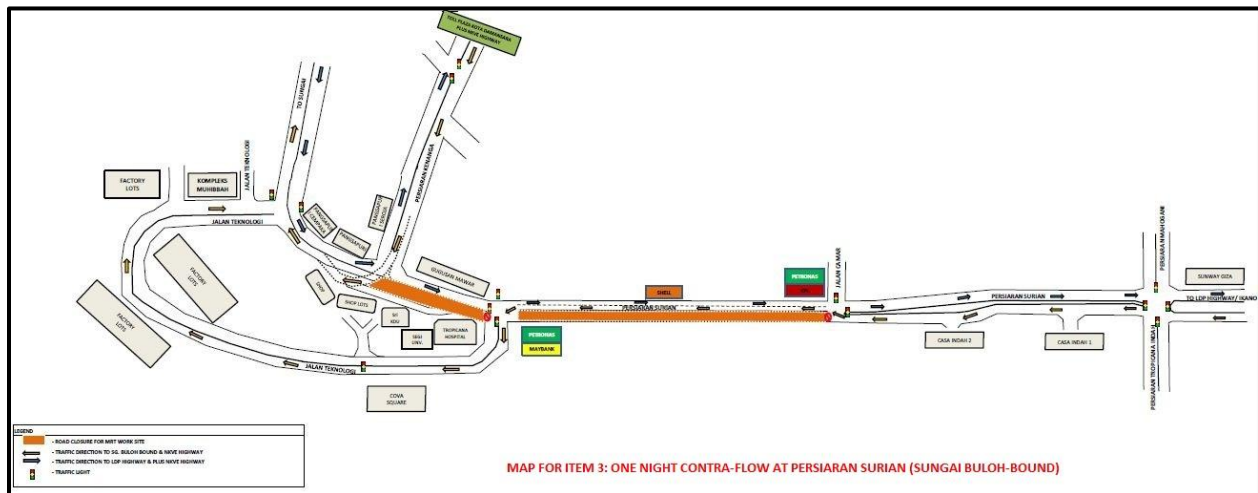

For media enquiries, please contact:

Subba Rao (Item 1 & Item 2)

Juliana Johari Tan (Item 3)

Ong Jee Lian (Item 1, Item 2 and Item 3)

Tel: +6019 1136806

Tel: +6019 3558322

Tel: +603 7493 3963

srao@sunway.com.my

Juliana@gadang.com.my

jeelian@mgjvkvmt.com.my

MMC GAMUDA KVMRT (PDP) SDN BHD (927050-H)

Block A, Level 7, Menara Mustapha Kamal, PJ Trade Centre, No 8, Jalan PJU 8/8A,

Bandar Damansara Perdana, 47820 Petaling Jaya, Selangor, Malaysia

T: 603 7494 2200 F: 603 7722 2643 www.kvmrt.com.my