

MEDIA RELEASE

REVISED TIMING OF ONE-NIGHT CLOSURE AT SPRINT HIGHWAY/JALAN SEMANTAN

Kuala Lumpur, 26 February 2014: Mass Rapid Transit Corporation Sdn Bhd (MRT Corp) refers to an earlier traffic announcement sent on Wednesday, 25 February 2014 entitled *“One-night Closure at Sprint Highway/Jalan Semantan – PJ-bound, starting at Istana Pintu 2 ramp”*.

The announcement had stated that the closure will take place on 28 February 2014, from 12:00am to 5:00am. This one-night closure has however, been delayed by 22 hours to **28 February 2014, from 10:00pm to 6:00am.**

Motorists from Kuala Lumpur heading towards Petaling Jaya on Sprint Highway/Jalan Semantan will be diverted up the ramp to Istana Pintu 2 into Lorong Dungun, straight to Jalan Gelenggang, then left to Jalan Beringin towards underneath the flyover to join Sprint Highway. *(Please refer to appended map.)*

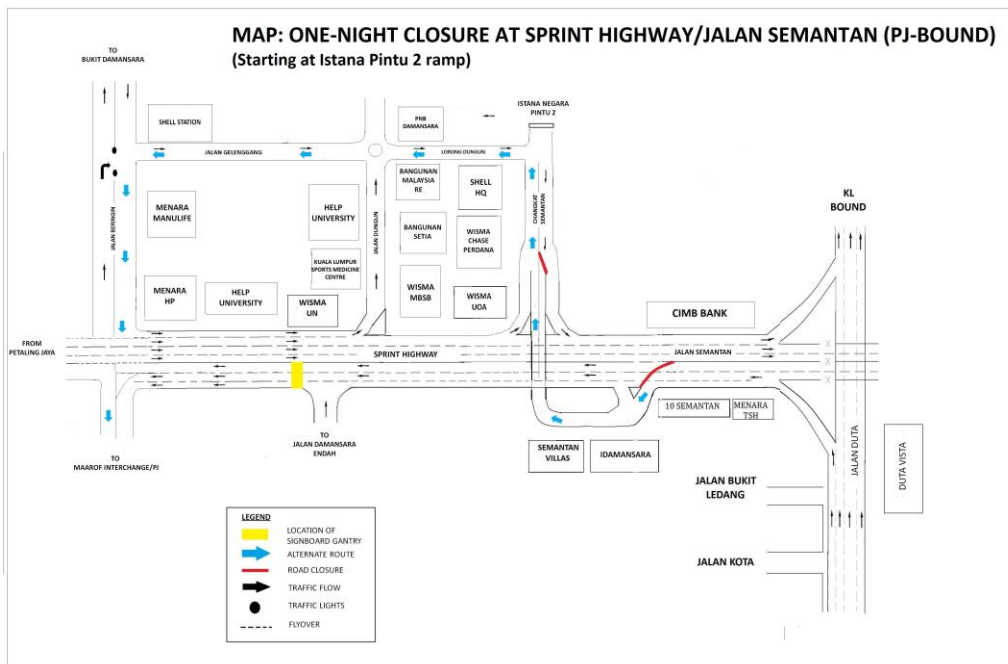



This closure is necessary to safeguard public safety during the removal of a signboard gantry, located near the Jalan Damansara Endah/Jalan Semantan junction. A certain level of noise and vibration is expected during this period.

ENDS

About the MRT Project

MRT is a new rail transport system for the Klang Valley. It is part of the government's Greater Kuala Lumpur/Klang Valley's National Key Economic Area (NKEA), under the Economic Transformation Programme. The Sungai Buloh – Kajang (SBK) Line runs for 51kms, from the north-west town of Sg Buloh to the south-east city town of Kajang. Upon completion, it will comprise 31 stations, and serve 1.2 million people along the route. It will also have strategic integration with KL's existing rail transport network, namely the LRT, Monorail and KTM Komuter, as well as intra and inter-city bus routes. The end result will be better connectivity for KL and its surrounding cities, while reducing the number of cars that enter the capital.

MRT Corp wishes to apologise for any temporary inconvenience caused to the public during the construction of this world-class public transport facility that will benefit Malaysians at large. For more information on traffic diversion, the public can visit the MRT website at www.mymrt.com.my or www.mymrt-underground.com.my, twitter @MRTMalaysia or twitter @MyMRT Underground or call the MRT Hotline at 1-800-82-6868.

For media enquiries, please contact:

Mrs. Ong Jee Lian
MMC-Gamuda KVMRT (PDP) Sdn Bhd

03-74933963 / jeelian@gjv-kvmrt.com.my

Ms. Nadia Azmi
MRT Corp

03-20813185 / nadia.azmi@mymrt.com.my