

## MEDIA RELEASE

# ONE-NIGHT CLOSURE AT SPRINT HIGHWAY (KL-BOUND)

**Kuala Lumpur, 8 October 2013:** Mass Rapid Transit Corporation Sdn Bhd (MRT Corp) wishes to announce that the Sprint Highway (KL-bound) from the exit of Jalan Setiapuspa towards the exit to Jalan Johar, will undergo a full closure on **10 October 2013 from 12:00am to 5:00am (Thursday morning)**.

Motorists from Petaling Jaya or Jalan Setia Puspa heading towards Kuala Lumpur or Jalan Maarof, will be directed to Jalan Kasah then to Jalan Johar before connecting back to Sprint Highway. *(Please refer to appended map.)*

As part of the safety measures for the live traffic, a full closure is necessary to facilitate the removal of gantry which is located between Victoria Station Restaurant and Wisma Lensa. A certain level of noise and vibration is expected. Sufficient directional signs will be placed while any removed signs will be replaced accordingly.

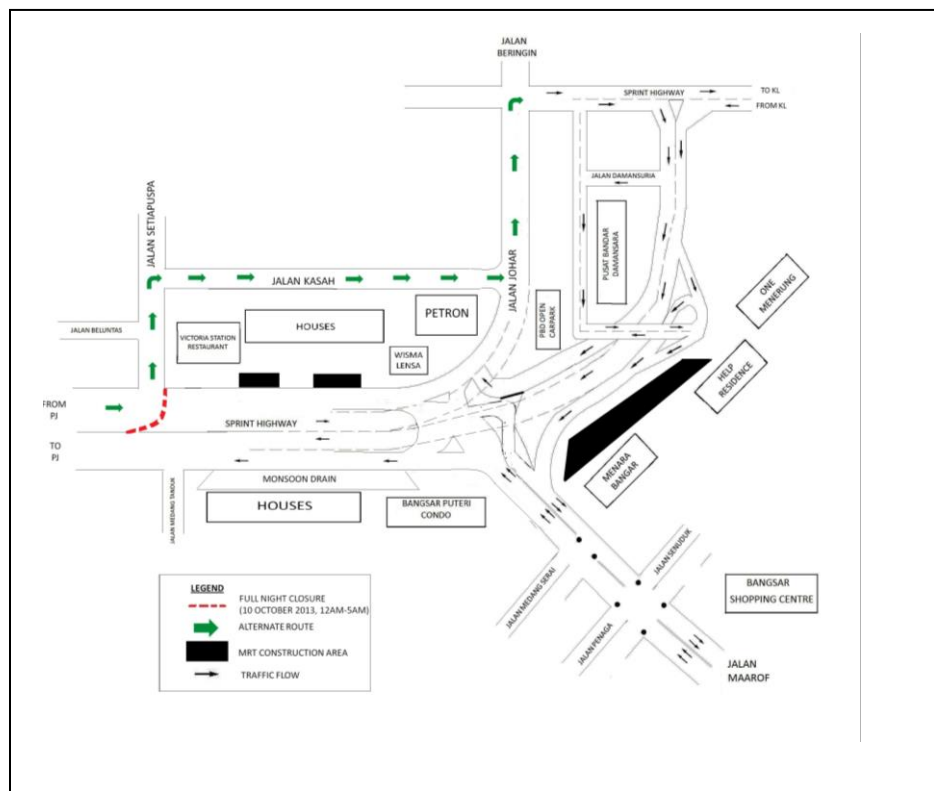



## **About the MRT Project**

*MRT is a new rail transport system for the Klang Valley. It is part of the government's Greater Kuala Lumpur/Klang Valley's National Key Economic Area (NKEA), under the Economic Transformation Programme. The Sungai Buloh – Kajang (SBK) Line runs for 51kms, from the north-west town of Sg Buloh to the south-east city town of Kajang. Upon completion, it will comprise 31 stations, and serve 1.2 million people along the route. It will also have strategic integration with KL's existing rail transport network, namely the LRT, Monorail and KTM Komuter, as well as intra and inter-city bus routes. The end result will be better connectivity for KL and its surrounding cities, while reducing the number of cars that enter the capital.*

*MRT Corp wishes to apologise for any temporary inconvenience caused to the public during the construction of this world-class public transport facility that will benefit Malaysians at large. For more information on traffic diversion, the public can visit the MRT website at [www.mymrt.com.my](http://www.mymrt.com.my) or [www.mymrt-underground.com.my](http://www.mymrt-underground.com.my), twitter @MRTMalaysia or twitter @MyMRT Underground or call the MRT Hotline at 1-800-82-6868.*

***For media enquiries, please contact:***

***Mrs. Ong Jee Lian***  
*MMC-Gamuda KVMRT (PDP) Sdn Bhd*

***03-74933963 / [jeelian@mgjv-kvmrt.com.my](mailto:jeelian@mgjv-kvmrt.com.my)***

***Ms. Nadia Azmi***  
*MRT Corp*

***03-20813185 / [nadia.azmi@mymrt.com.my](mailto:nadia.azmi@mymrt.com.my)***