

TRAFFIC ANNOUNCEMENT
LANE CLOSURE ALONG JALAN RAYA 1
SERI KEMBANGAN
28/10/2017

Date	30 October 2017 - 19 January 2018
Time	24 hours
Duration	81 Days
Reason	To facilitate preparation for tree cutting, piloting and relocation of underground utilities, and soil investigation

There will be one lane closure on the right-most lane on Jalan Raya 1 from Balai Bomba until Dataran Mutiara intersection (both bound), from **30 October 2017 until 19 January 2018**.

The 170 meters one lane closure on both bound is necessary to facilitate preparation for tree cutting, piloting and relocation of underground utilities, and soil investigation at Jalan Raya 1. During this closure, one lane will be available for motorists.

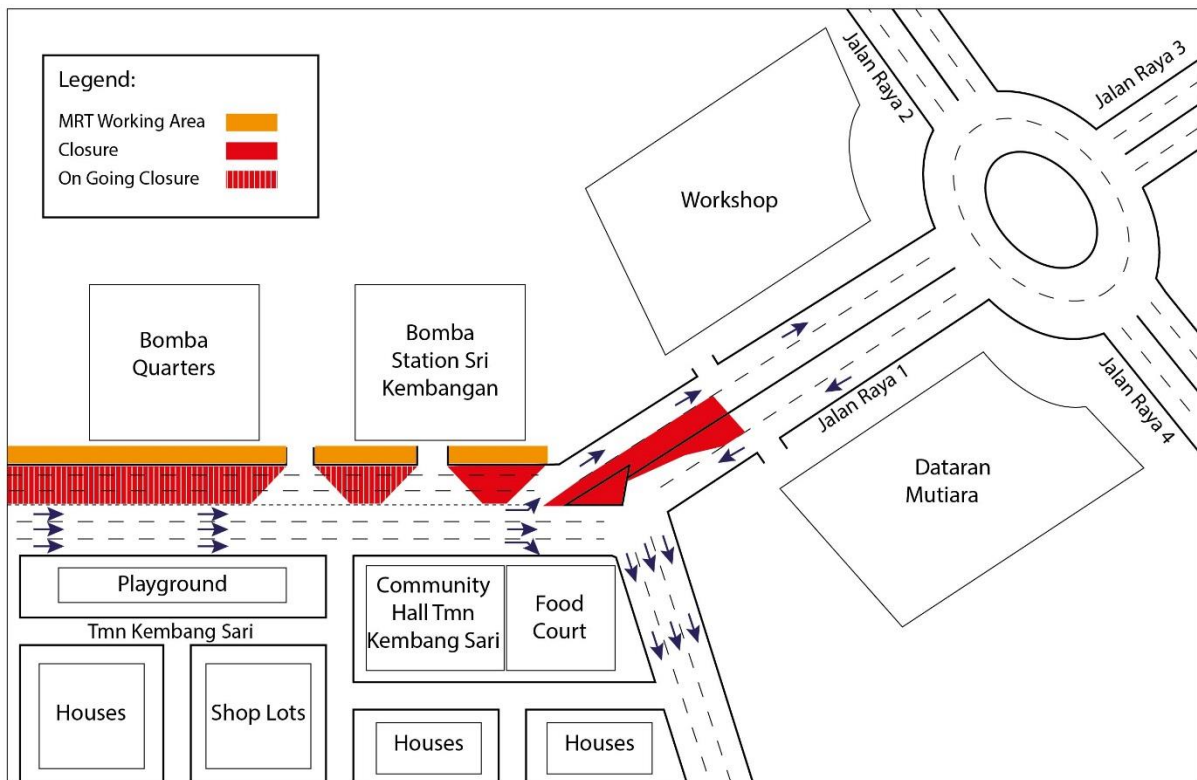

For media enquiries, please contact:

Juliana J. Tan

Tel: +6019 - 355 8322

juliana@gadang.com.my

Leanne Susau

Tel: +603 7493 3832

leanne@mgjv-kvmrt.com.my

MMC GAMUDA KVMRT (PDP SSP) SDN BHD (1117100-V)

Block A, Level 17, Menara Mustapha Kamal, PJ Trade Centre

No 8, Jalan PJU 8/8A, Bandar Damansara Perdana, 47820 Petaling Jaya

Selangor Darul Ehsan, Malaysia

T: +603-7494 2222 F: +603-7727 0222 <http://www.mymrt.com.my>