

TRAFFIC ANNOUNCEMENT

UPDATES ON TRAFFIC MANAGEMENT PLAN FOR MRT SSP CONSTRUCTION ALONG JALAN BESAR KEPONG, PUTRAJAYA AND CYBERJAYA

30 JUNE 2017

1. LANE CLOSURES ALONG JALAN BESAR KEPONG (SUNGAI BULOH-BOUND AND JINJANG-BOUND)

Date	03 July 2017 – 31 July 2017
Time	11:00pm – 6:00am
Duration	28 days
Reason	To facilitate utilities detection and relocation works along Jalan Kepong for MRT SSP Line

There will be lane closures along Jalan Besar Kepong (Sungai Buloh-bound and Jinjang-bound) starting from **03 July 2017 until 31 July 2017, 11:00pm to 6:00am, intermittently**. The traffic management plan involves the following closures:

Closure A: Partial lane closure for a stretch of 200 metres starting from Jalan Besar Kepong until the slip road entering Jalan Metro Perdana Barat (Jinjang-bound).

Closure B: Partial lane closure for a stretch of 150 metres starting from the slip road exiting Jalan Metro Perdana Barat heading towards Jinjang (Jinjang-bound).

Closure C: Partial lane closure along Jalan Kepong (Sungai Buloh-bound) for a stretch of 100 metres starting from the junction of Jalan Ambong Kiri until the junction of Jalan Ambong.

Closure D: Partial lane closure along Jalan Kepong (Sungai Buloh-bound) for a stretch of 100 metres starting in front of the Hong Leong Bank entering Jalan Ambong Kiri.

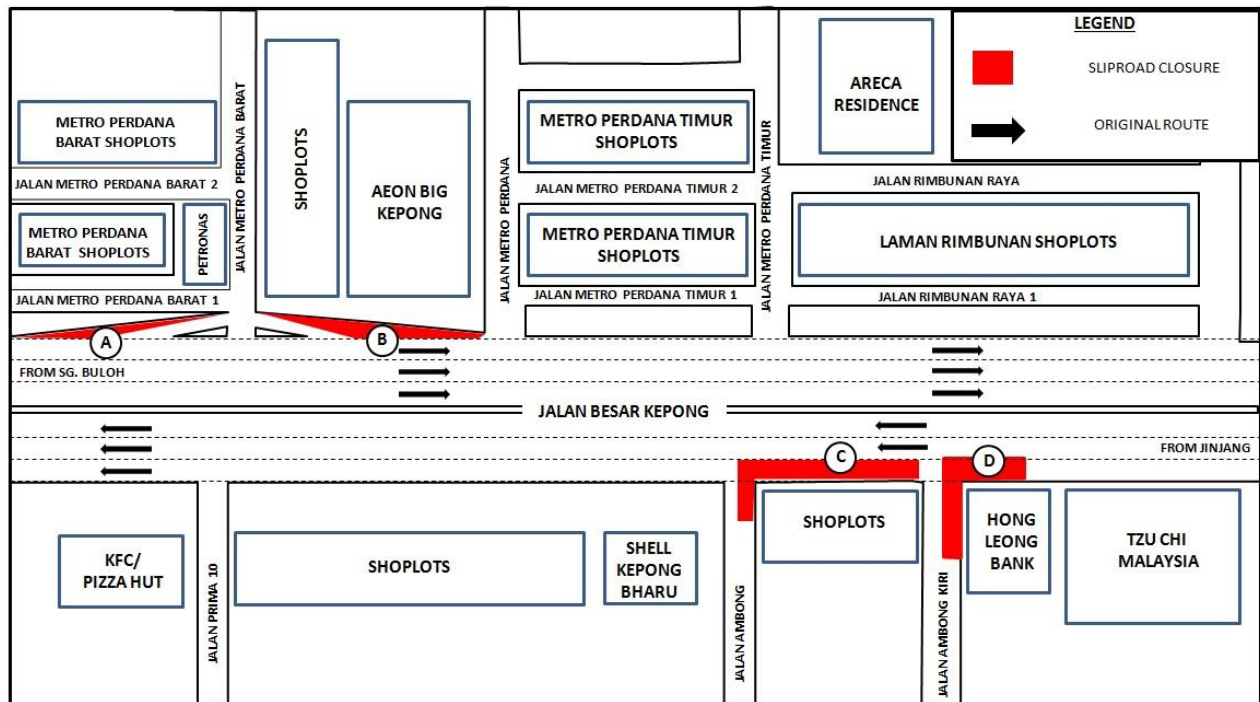

MAP 1 : LANE CLOSURES ALONG JALAN BESAR KEPONG (SUNGAI BULOH-BOUND AND JINJANG-BOUND)

2. LANE CLOSURE ALONG JALAN P9 TOWARDS PUTRAJAYA SENTRAL STATION, PUTRAJAYA (NORTH-BOUND)

Date	04 July 2017 – 09 October 2017
Time	9:00am to 4:30pm & 6:00pm to 10.00pm
Duration	3 month 4 days
Reason	To facilitate site clearing, soil investigation, piloting, bore pile and pier construction for MRT Project

There will be a long-term full lane closure towards Putrajaya Sentral Station starting from **04 July 2017 to 09 October 2017**, at the following time:

- **Monday to Friday: 9:00am – 4:30pm & 6:00pm – 10:00pm**
- **Saturday, Sunday and Public Holidays: 7:00am – 10:00pm**

During this closure, motorists are advised to drop-off passengers at the covered walkway (as indicated in the map) and make the U-Turn at the new drop-off area to head back to Jalan P9 (North-bound). Meanwhile, motorists wanting to park their vehicles to ride the train can proceed to the replacement carpark area.

This full lane closure only will be implemented on the route towards Putrajaya Sentral Station. All other lanes along Jalan P9 will not be affected.

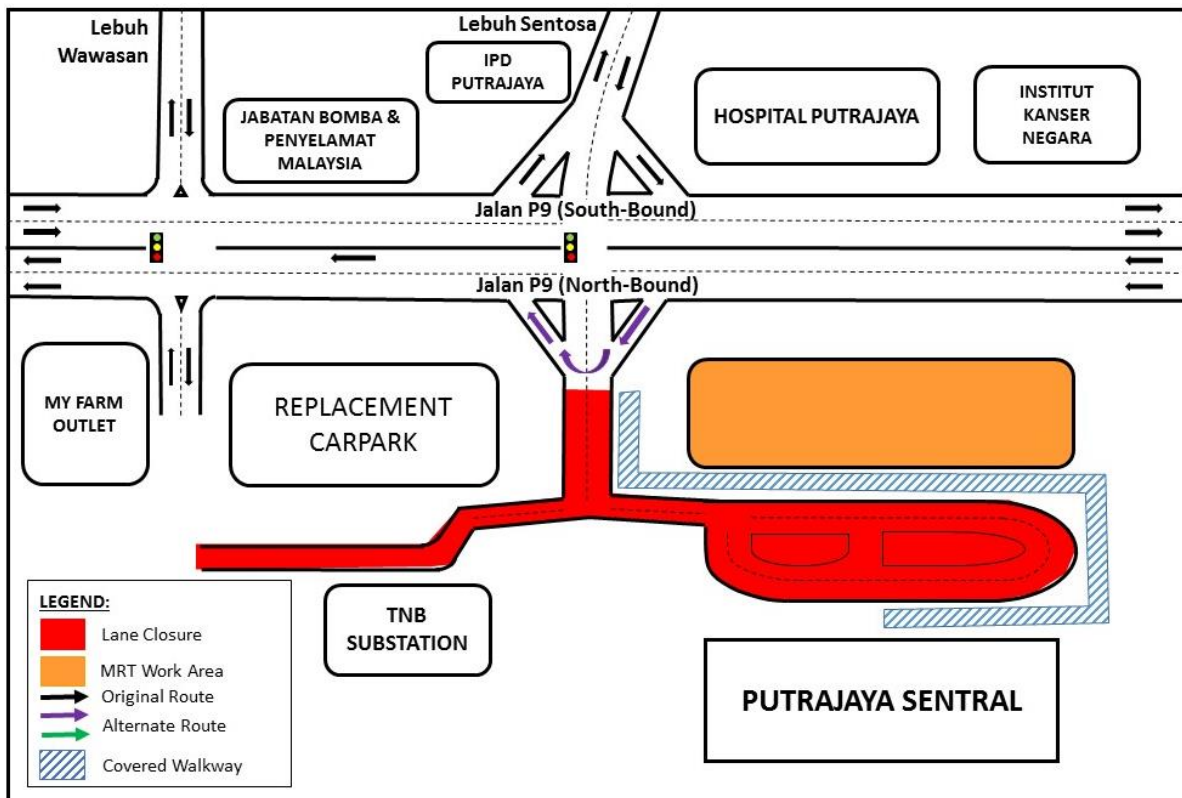

MAP 2 : LANE CLOSURE ALONG JALAN P9 TOWARDS PUTRAJAYA SENTRAL STATION, PUTRAJAYA (NORTH-BOUND)

3. INTERMITTENT LANE CLOSURES AND CONTRA-FLOW ALONG PERSIARAN APEC, CYBERJAYA (NORTH-BOUND AND SOUTH-BOUND)

Date	08 July 2017 – 31 July 2017
Time	12:00am – 6:00am
Duration	Saturdays and Sundays only
Reason	To facilitate unloading and installation of TNB manhole for MRT construction works

There will be full lane closures along Persiaran APEC (South-bound) heading to Cyberjaya for a stretch of 200 metres from **08 July until 31 July (Saturdays and Sundays only)** between **12:00am to 6:00am, intermittently**.

During this night contra-flow period, motorists are advised to follow the alternative route as indicated in **PURPLE** in the appended map below.

Meanwhile, motorists from Cyberjaya wanting to turn right to Persiaran Harmoni will need to go straight and make the U-turn near Skypark (indicated in **GREEN** in the appended map below).

During these closures, there will also be flagmen to facilitate the traffic flow. The lane closures and contra-flow will be implemented on **weekends (Saturdays and Sundays) only**. Persiaran APEC will remain open to traffic on weekdays.

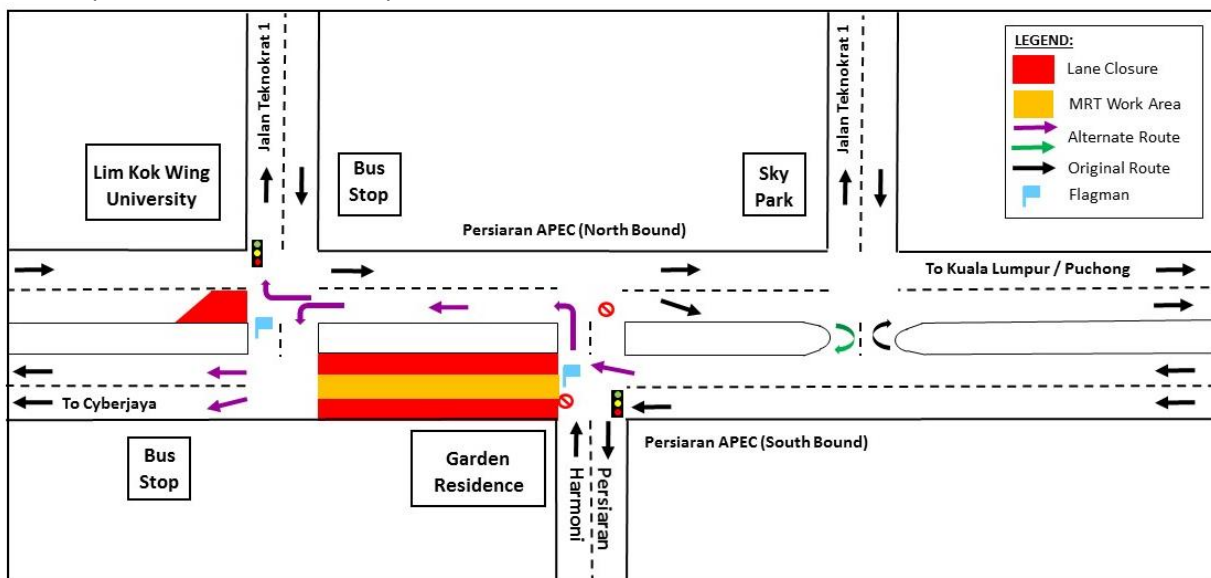

MAP 3 : INTERMITTENT LANE CLOSURES AND CONTRA-FLOW ALONG PERSIARAN APEC, CYBERJAYA (NORTH-BOUND AND SOUTH-BOUND) (NORTH-BOUND AND SOUTH-BOUND)

For media enquiries, please contact:

Zaini Ghazali (**Item 1**)

Tel: +6012 328 1821

zainighazali@azrb.com

Mohd Hisham Abu Bakar (**Item 2-3**)

Tel: +6017 447 2767

hisham.bakar@mrcb.com

Leanne Ann Susau (**Item 1-3**)

Tel: +603 7493 3832

leanne@mgjv-kvmrt.com.my

MMC GAMUDA KVMRT (PDP SSP) SDN BHD (1117100-V)

Block A, Level 17, Menara Mustapha Kamal, PJ Trade Centre

No 8, Jalan PJU 8/8A, Bandar Damansara Perdana, 47820 Petaling Jaya

Selangor Darul Ehsan, Malaysia

T: +603-7494 2222 F: +603-7727 0222 www.mymrt.com.my