

TRAFFIC ANNOUNCEMENT
UPDATES ON TRAFFIC MANAGEMENT PLAN FOR MRT SSP CONSTRUCTION ALONG
JALAN KEPONG (SUNGAI BULOH-BOUND AND JINJANG-BOUND) AND
PERSIARAN DAGANG

11 MAY 2017

1. EXTENSION OF ONE NIGHT FULL CLOSURE ALONG JALAN KEPONG (SUNGAI BULOH-BOUND AND JINJANG-BOUND)

| | |
|-----------------|---|
| Date | 12 May 2017 - 13 May 2017 |
| Time | 10pm – 7am |
| Duration | 1 day |
| Reason | To facilitate dismantling of the pedestrian bridge in front of AEON Mall for MRT construction works |

MMC-Gamuda KVMRT (PDP SSP) Sdn Bhd wishes to announce an extension of **one night full closure** along Jalan Kepong (Sungai Buloh-bound and Jinjang-bound) in front of Aeon Mall Kepong, which will be implemented on the **12th of May 2017, from 10pm to 7am**. The extension in closure timing will only be effective for **one day** and it is necessary to ensure the dismantling of the pedestrian bridge is completed successfully.

The earlier announcement on the closure was from **3 May 2017 until 18 May 2017, 11pm to 6am (daily), intermittently**. During the closure, motorist are advised to use these following routes:

Motorist from Sungai Buloh heading to Jinjang : Motorist are advised to turn left to Jalan Metro Perdana Barat 14, then take either the right turn to Jalan Metro Perdana Barat 2 or Jalan Metro Perdana Barat 4 before turning right again to Jalan Metro Perdana Barat and proceed to Jalan Kepong (as indicated by **green** arrows in the appended map).

Motorist from Jinjang heading to Sungai Buloh : Motorist are advised to turn left to Jalan Metro Prima, then take the right turn to Jalan Metro 1 before turning right again to Jalan Metro 2 and proceed to Jalan Kepong (as indicated by **blue** arrows in the appended map).

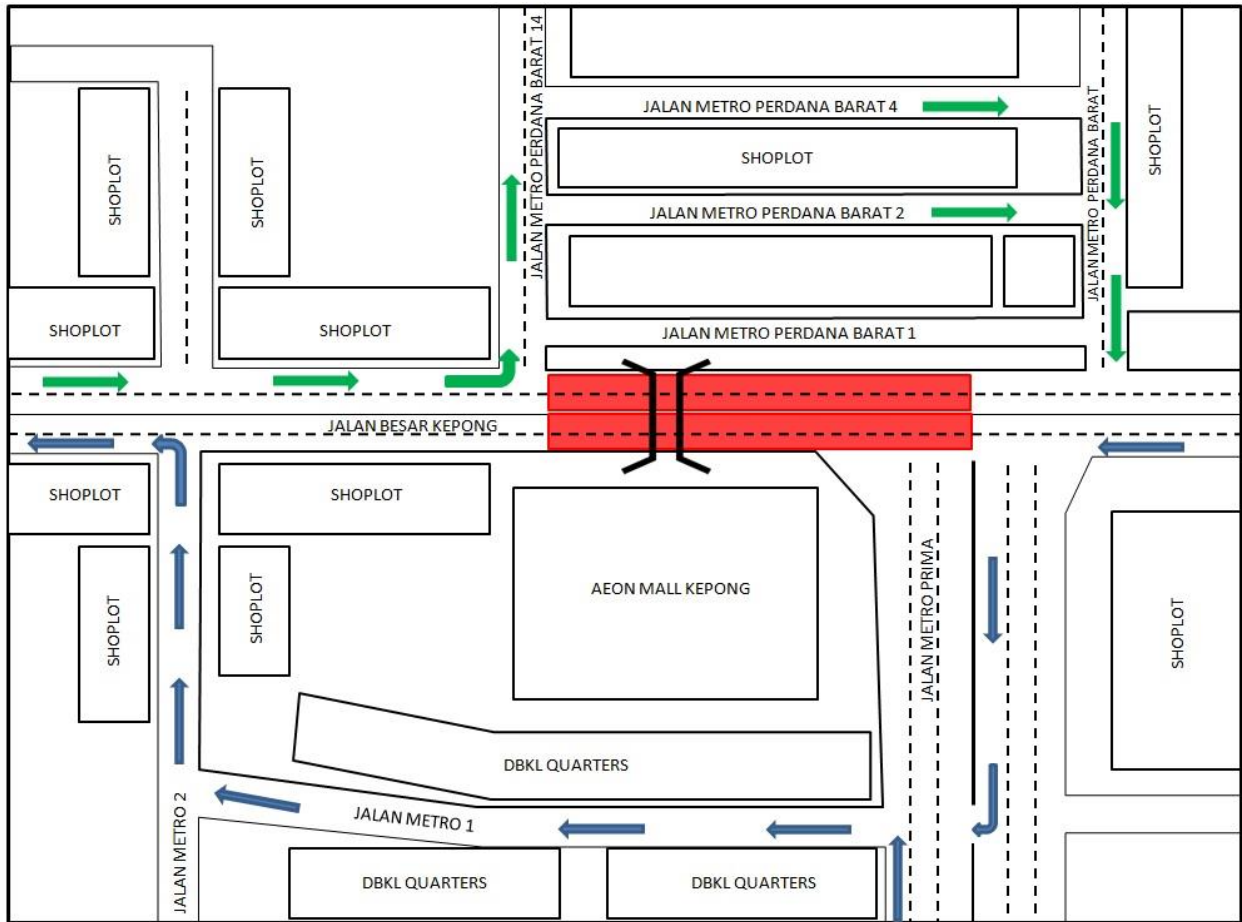

MAP 1: EXTENSION OF ONE NIGHT FULL CLOSURE ALONG JALAN KEPONG (SUNGAI BULOH-BOUND AND JINJANG-BOUND)

2. LEFT LANE CLOSURE ALONG JALAN KEPONG (SUNGAI BULOH-BOUND)

| | |
|-----------------|---|
| Date | 12 May 2017 – 11 June 2017 |
| Time | 11pm – 6am |
| Duration | 14 days |
| Reason | To facilitate utilities detection and relocation works for construction of MRT SSP Line |

There will be left lane closure along Jalan Kepong (Sungai Buloh-bound) in front of Caltex, for a stretch of 200 metres starting from **12 May 2017 until 25 May 2017, 11pm to 6am (daily) intermittently**.

During this closure, the remaining two (2) lanes will be made available for motorist along Jalan Kepong heading to Sungai Buloh.

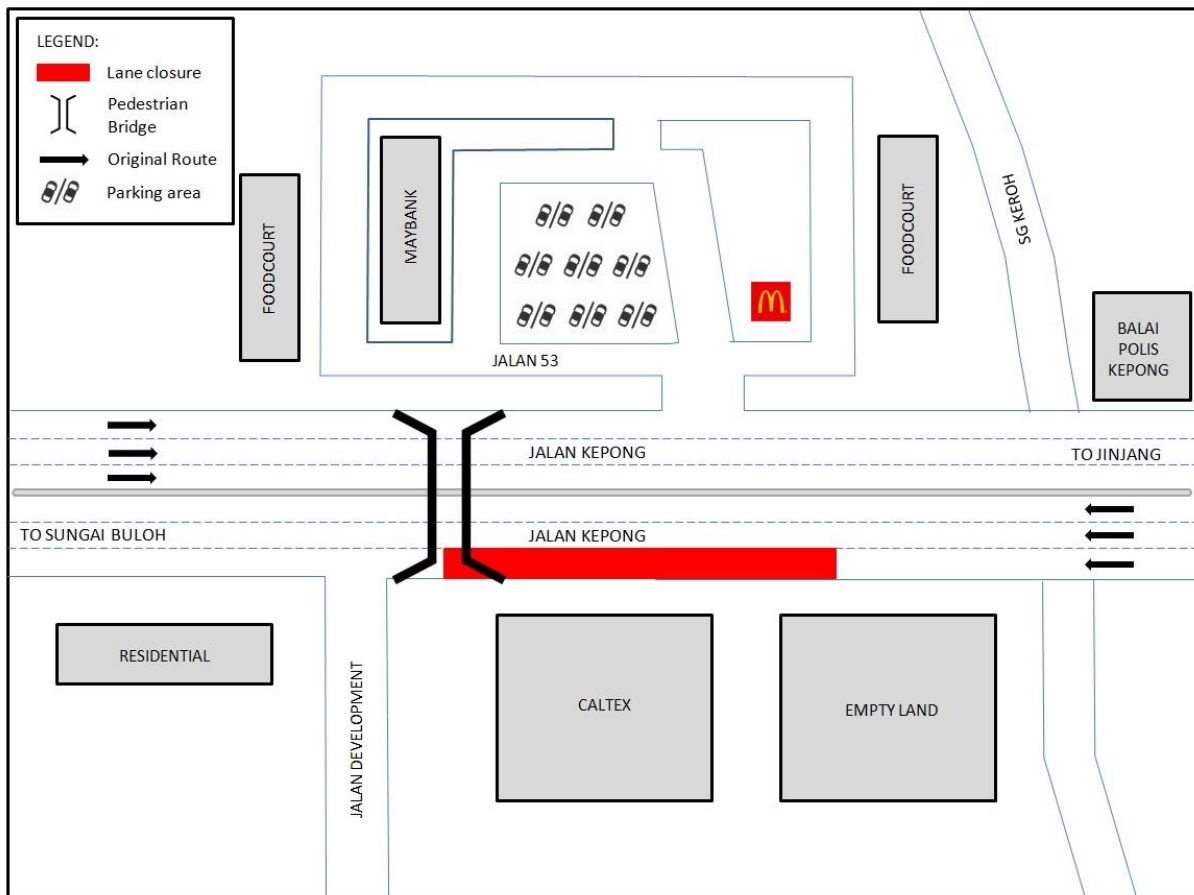

MAP 2: LEFT LANE CLOSURE ALONG JALAN KEPONG (SUNGAI BULOH-BOUND)

3. ONE LANE CLOSURE ALONG PERSIARAN DAGANG, BANDAR SRI DAMANSARA

| | |
|-----------------|---|
| Date | 12 May 2017 – 11 June 2017 |
| Time | 8am – 6pm |
| Duration | 30 days |
| Reason | To facilitate utilities relocation works for construction of MRT SSP Line |

There will be one (1) lane closure along Persiaran Dagang, Bandar Sri Damansara (Kepong-bound) from **12 May 2017 until 11 June 2017, 8am to 6 pm (daily), intermittently**.

During this closure, motorist will be diverted to the opposite lane by flagmen at both directions using the "STOP and GO" method of traffic flow.

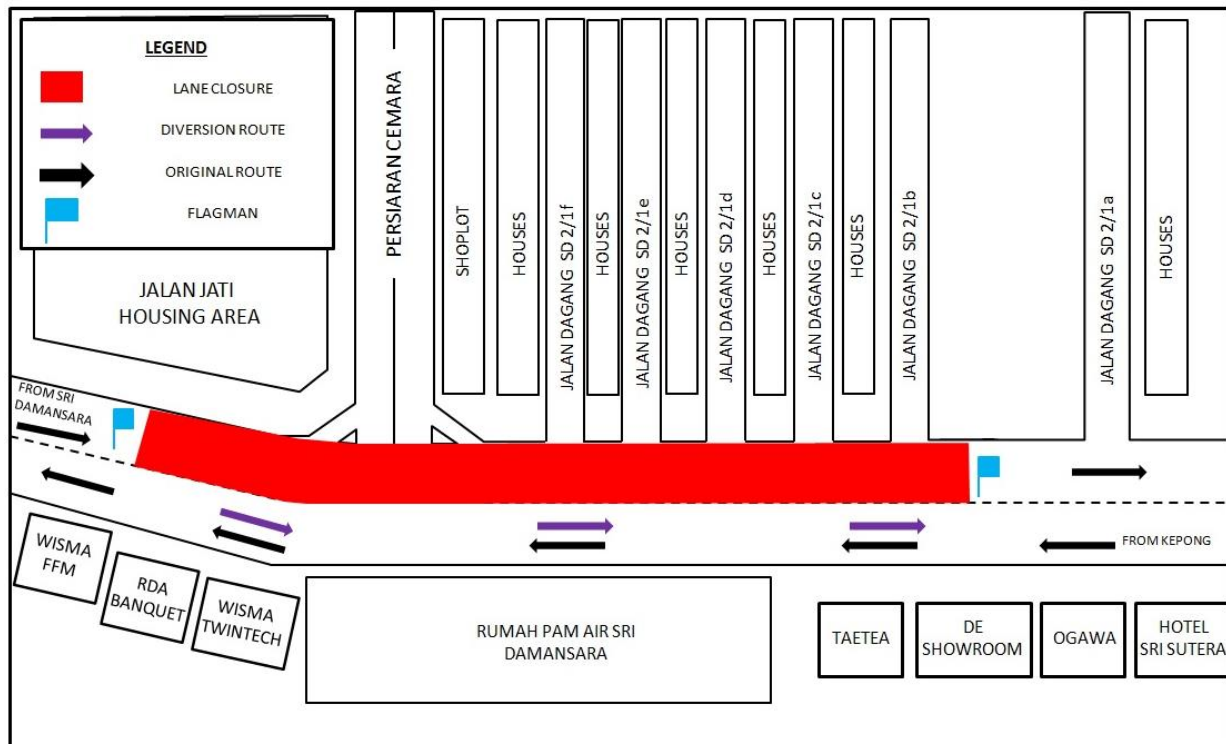

MAP 3: ONE LANE CLOSURE ALONG PERSIARAN DAGANG, BANDAR SRI DAMANSARA

For media enquiries, please contact:

Zaini Ghazali
Leanne Ann Susau

Tel: +6012 328 1821
Tel: +603 7493 3832

zainighazali@azrb.com
leanne@mgjv-kvmrt.com.my

MMC GAMUDA KVMRT (PDP SSP) SDN BHD (1117100-V)
Block A, Level 17, Menara Mustapha Kamal, PJ Trade Centre
No 8, Jalan PJU 8/8A, Bandar Damansara Perdana, 47820 Petaling Jaya
Selangor Darul Ehsan, Malaysia
T: +603-7494 2222 F: +603-7727 0222 www.mymrt.com.my