

TRAFFIC ANNOUNCEMENT
UPDATES ON TRAFFIC MANAGEMENT PLAN FOR MRT SSP CONSTRUCTION ALONG JALAN
KEPONG AND JALAN JINJANG PERMAI 3
06 APRIL 2017

1. LANE CLOSURES ALONG JALAN KEPONG (SUNGAI BULOH-BOUND AND JINJANG-BOUND)

Date	08 April 2017 - 28 April 2017
Time	11pm – 6am
Duration	20 days
Reason	To facilitate demolition of the pedestrian bridge in front of AEON Mall for MRT construction works

There will be lane closures along Jalan Kepong (Sungai Buloh-bound and Jinjang-bound) in front of AEON Mall Kepong, starting from **8 April 2017 until 28 April 2017, 11pm to 6am (daily), intermittently**. During the closure, motorists are advised to use the following routes:

Motorist from Sungai Buloh heading to Jinjang : Motorist are advised to turn left onto Jalan Metro Perdana Barat 14 and turn right either to Jalan Metro Perdana Barat 2 or Jalan Metro Perdana Barat 4 before turning right again onto Jalan Metro Perdana Barat to join back Jalan Kepong (as indicated by the **green** arrows in the appended map).

Motorist from Jinjang heading to Sungai Buloh : Motorist are advised to turn left onto Jalan Metro Prima, turn right at Jalan Metro 1, and turn right at Jalan Metro 2 to join back Jalan Kepong (as indicated by **blue** Arrow in the appended map).

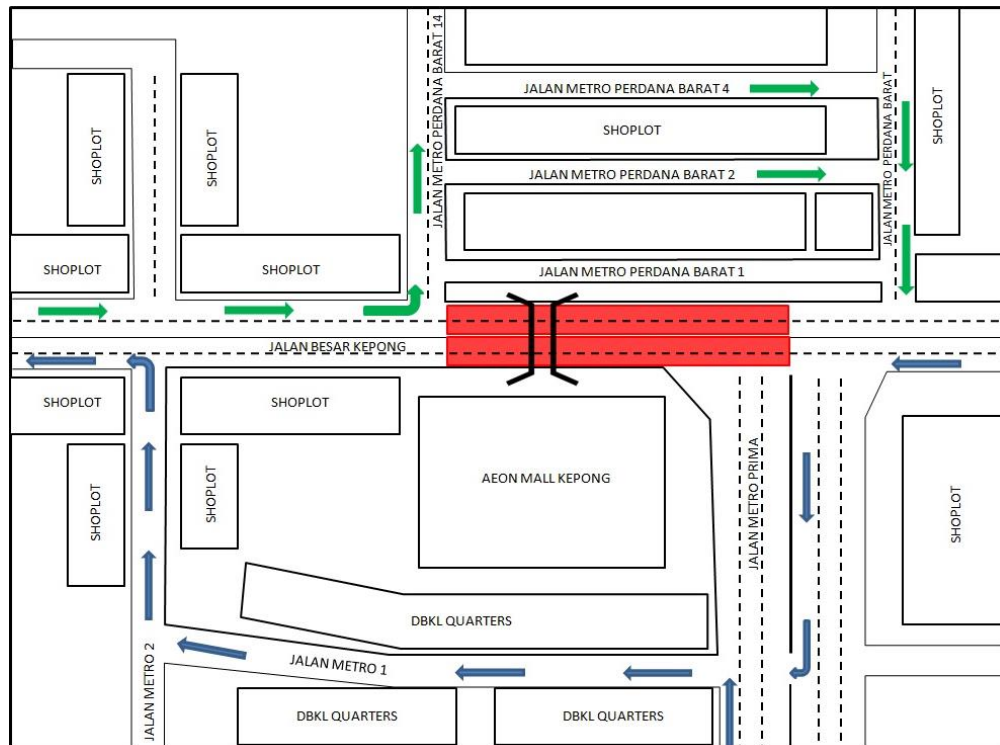

MAP 1 : LANE CLOSURES ALONG JALAN KEPONG (SUNGAI BULOH-BOUND AND JINJANG-BOUND)

2. CONTINUATION OF NIGHT LANE CLOSURES BY STAGES ALONG JALAN JINJANG PERMAI 3 & JALAN KEPONG (KEPONG BOUND AND KL-BOUND)

Date	08 April 2017 – 15 May 2017
Time	10pm – 6am
Duration	38 days
Reason	To facilitate utilities relocation and any other related activities for MRT construction works.

There will be a continuation of night lane closures by stages along Jalan Jinjang Permai 3 (nearby Wisma TNB Kepong) and Jalan Kepong (Kepong-bound and KL-bound) from **08 April 2017 to 15 May 2017, 10pm - 6am intermittently**.

The traffic management plan involves the following closures:

Map 1

- Jalan Kepong (Kepong-bound) - Slow and middle lane closures from Jinjang Funeral Parlor to CIMB Bank.
- Jalan Kepong (KL-bound) - Slow and middle lane closures nearby Wisma TNB Kepong.
- Jalan Jinjang Permai 3 (nearby Wisma TNB Kepong) – Internal road closure for a stretch of 180 metres by stages. During this closure, motorist can use Jalan Jinjang Permai 2 to go to Wisma TNB Kepong.

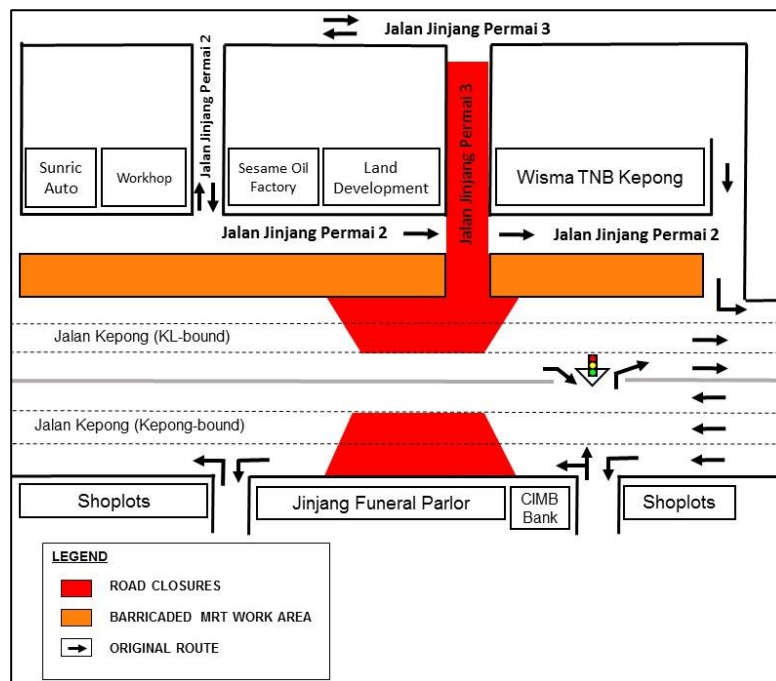

MAP 2 : CONTINUATION OF NIGHT LANE CLOSURES BY STAGES ALONG JALAN JINJANG PERMAI 3 & JALAN KEPONG (KEPONG-BOUND AND KL-BOUND)

Map 2

- Jalan Kepong (Kepong-bound) - Middle and fast lane closures from Jinjang Funeral Parlor to CIMB Bank.
- Jalan Kepong (KL-bound) - Middle and fast lane closures nearby Wisma TNB Kepong.
- Jalan Jinjang Permai 3 (nearby Wisma TNB Kepong) – Internal road closure for a stretch of 180 metres by stages. During this closure, motorist can use Jalan Jinjang Permai 2 to go to Wisma TNB Kepong.

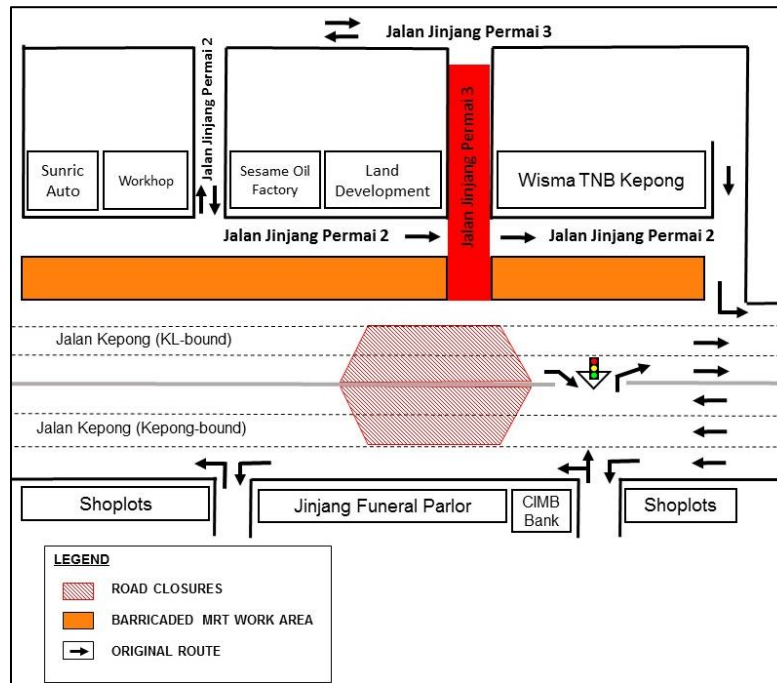

MAP 3 : CONTINUATION OF NIGHT LANE CLOSURES BY STAGES ALONG JALAN JINJANG PERMAI 3 & JALAN KEPONG (KEPONG-BOUND AND KL-BOUND)

The closures will be implemented intermittently and at any one time there will be one (1) lane made available for motorists on both bounds.

For media enquiries, please contact:

Zaini Ghazali (Item 1)

Tel: +6012 328 1821

zainighazali@azrb.com

Juliet Choong Wai Gaik (Item 2)

Tel: +6012 601 0318

julietchoong@ijm.com

Leanne Ann Susau (Item 1-2)

Tel: +603 7493 3832

leanne@mgjv-kvmrt.com.my

MMC GAMUDA KVMRT (PDP SSP) SDN BHD (1117100-V)
Block A, Level 17, Menara Mustapha Kamal, PJ Trade Centre
No 8, Jalan PJU 8/8A, Bandar Damansara Perdana, 47820 Petaling Jaya
Selangor Darul Ehsan, Malaysia
T: +603-7494 2222 F: +603-7727 0222 www.mymrt.com.my