

**TRAFFIC ANNOUNCEMENT
 UPDATES ON TRAFFIC MANAGEMENT PLAN FOR MRT SSP CONSTRUCTION
 AT PERSIMPANGAN PUTRAJAYA SENTRAL AND LEBUHRAYA PINTASAN DENGKIL
 31 MARCH 2017**

1. LONG TERM LANE CLOSURES AT PERSIMPANGAN PUTRAJAYA SENTRAL, PUTRAJAYA

Date	1 April 2017 - 9 October 2017
Time	9:00AM to 10:00PM & 7:00AM to 10:00PM
Duration	6 months
Reason	To facilitate road widening, traffic diversion, piloting, installation of sheet pile, TNB & CCTV relocation and any construction works related to MRT SSP line.

There will be long term lane closures along Lebuhraya Pintasan Dengkil heading towards Persimpangan Putrajaya Sentral from **1 April 2017 to 9 October 2017**, intermittently at the following time:

Monday to Friday: 9:00AM to 10:00PM

Saturday, Sunday and Public Holidays: 7:00AM to 10:00PM

The traffic management plan involves the following stages:

Closure A: One lane closure for a stretch of 100 metres heading towards Taman DeCare, Putrajaya.

Motorists from Presint 7 Putrajaya heading to Taman DeCare will be diverted to the opposite lane by flagman at both end using "STOP and GO" method of traffic flow (as indicated in **PURPLE** arrows in the map).

Closure B: Slip road closure of the ramp going down to Taman DeCare Putrajaya.

Motorists will be diverted to Taman DeCare exit to get to Presint 7 Putrajaya and Taman DeCare Putrajaya.

Partial left lane closure of the ramp going down to Putrajaya Sentral.

The closure will be implemented intermittently and at any one time there will be one (1) lane made available for motorists.

Closure C: Partial right lane closure of the ramp going down to Putrajaya Sentral.

The closures will be implemented intermittently and at any one time there will be one (1) lane made available for motorists.

Closure D: Left lane closure heading to Putrajaya Sentral for a stretch of 100 metres.

Motorists will be diverted to the right lane to get to Persimpangan Putrajaya Sentral.

There will be flagmen to facilitate traffic flows as indicated in the map. All other lanes along Lebuhraya Pintasan Dengkil will not be affected.

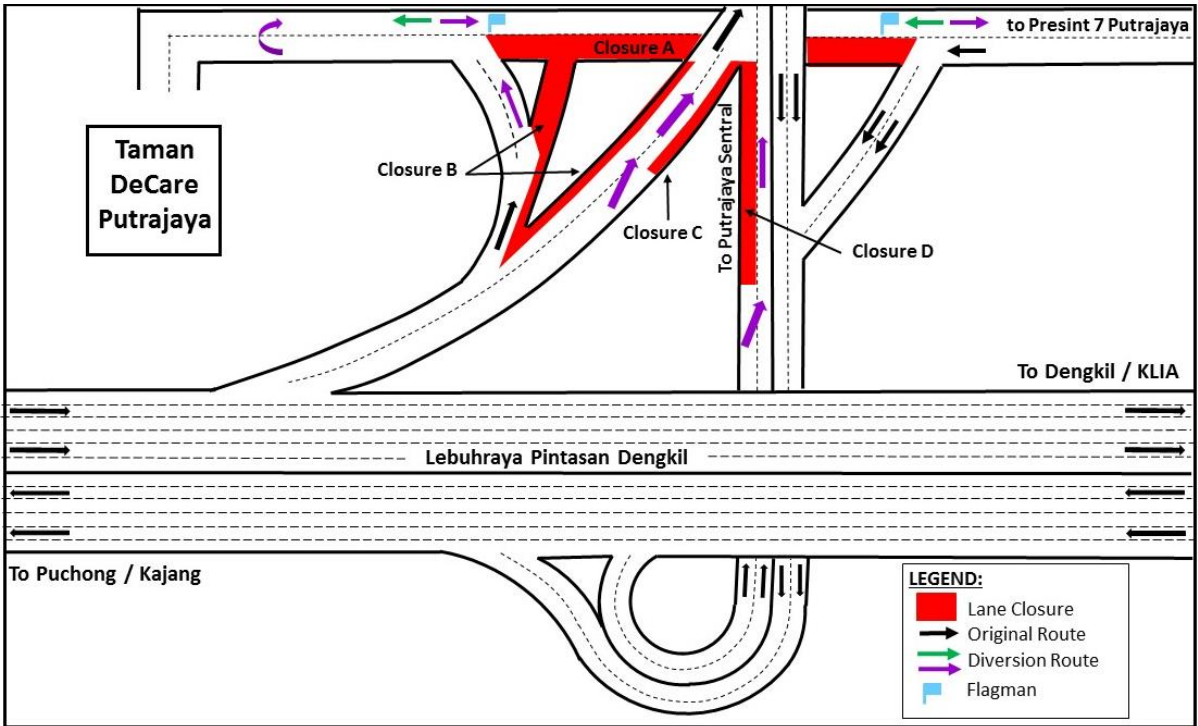

MAP 1: LONG TERM LANE CLOSURES AT PERSIMPANGAN PUTRAJAYA SENTRAL, PUTRAJAYA

2. LONG TERM RIGHT LANE CLOSURES ALONG LEBUHRAYA PINTASAN DENGKIL / PERSIMPANGAN PUTRAJAYA SENTRAL (PUCHONG/KAJANG-BOUND AND CYBERJAYA/DENGKIL-BOUND)

Date	3 April 2017 - 23 April 2017
Time	7:00AM - 7:00PM / 8:00PM - 6:00AM
Duration	20 Days
Reason	To facilitate mobilization of machinery, site clearing, soil investigation, piloting, and road widening and pier construction.

There will be right lane closures along Lebuhraya Pintasan Dengkil / Persimpangan Putrajaya Sentral from **3 April 2017 to 23 April 2017, 7am - 7pm and 8pm - 6am daily.**

The Traffic Management Plan that will take place as follow:

- Right lane closure for a stretch of 200 metres heading towards Puchong/Kajang.
- Right lane closure for a stretch of 200 metres heading towards Cyberjaya/Dengkil.

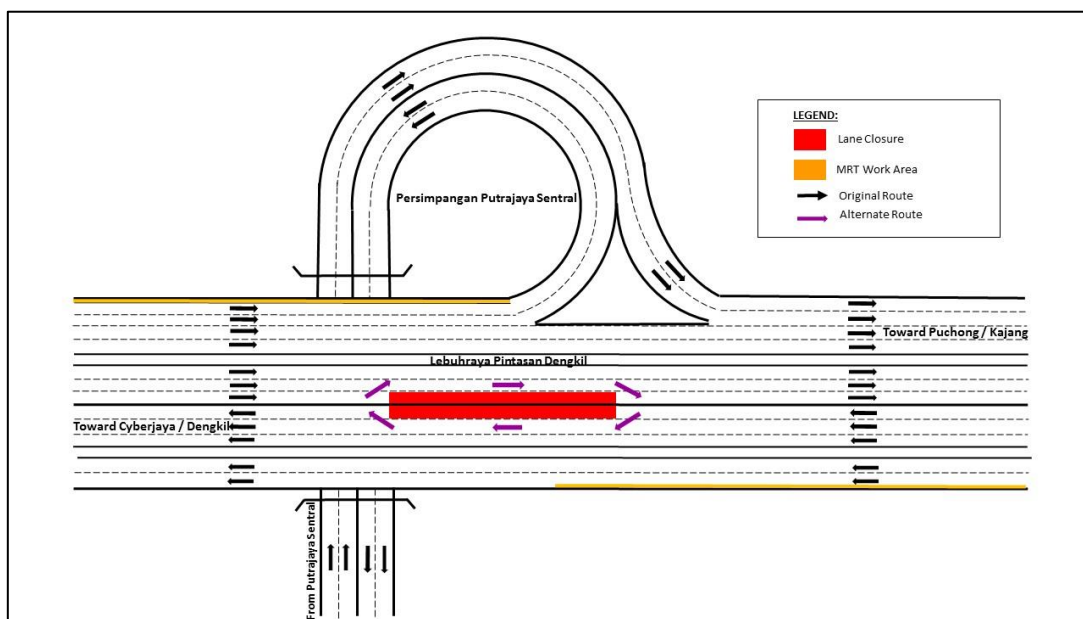

MAP 2: LONG TERM RIGHT LANE CLOSURES ALONG LEBUHRAYA PINTASAN DENGKIL / PERSIMPANGAN PUTRAJAYA SENTRAL (PUCHONG/KAJANG-BOUND AND CYBERJAYA/DENGKIL-BOUND)

During these closures, motorist using the right-most lane will be diverted to middle lane. All other lanes along Lebuhraya Pintasan Dengkil/Persimpangan Putrajaya will not be affected.

For media enquiries, please contact:

Mohd Hisham Abu Bakar
Leanne Ann Susau

Tel: +6017 447 2767
Tel: +603 7493 3832

hisham.bakar@mrcb.com
leanne@mgjv- kvmrt.com.my

MMC GAMUDA KVMRT (PDP SSP) SDN BHD (1117100-V)

Block A, Level 17, Menara Mustapha Kamal, PJ Trade Centre
No 8, Jalan PJU 8/8A, Bandar Damansara Perdana, 47820 Petaling Jaya
Selangor Darul Ehsan, Malaysia
T: +603-7494 2222 F: +603-7727 0222 www.kvmrt.com.my