

TRAFFIC ANNOUNCEMENT
UPDATES ON TRAFFIC MANAGEMENT PLAN FOR MRT SSP CONSTRUCTION ALONG JALAN
JINJANG PERMAI 3 AND JALAN KEPONG
2 MARCH 2017

1. NIGHT LANE CLOSURES BY STAGES ALONG JALAN JINJANG PERMAI 3 & JALAN KEPONG (KEPONG BOUND AND KL-BOUND)

Date	06 March 2017 - 06 April 2017
Time	10pm – 6am
Duration	1 month
Reason	To facilitate utilities relocation and any other related activities for MRT construction works.

There will be night lane closures by stages along Jalan Jinjang Permai 3 (nearby Wisma TNB) and Jalan Kepong (Kepong-bound and KL-bound) from **06 March 2017 to 06 April 2017, 10pm - 6am intermittently**.

The traffic management plan involves the following closures:

Map 1

- Jalan Kepong (Kepong-bound) - Slow and middle lane closures from Jinjang Funeral Parlor to CIMB Bank.
- Jalan Kepong (KL-bound) - Slow and middle lane closures nearby Wisma TNB Kepong.
- Jalan Jinjang Permai 3 (nearby Wisma TNB Kepong) – Internal road closure for a stretch of 180 metres by stages. During this closure, motorist can use Jalan Jinjang Permai 2 to go to Wisma TNB Kepong.

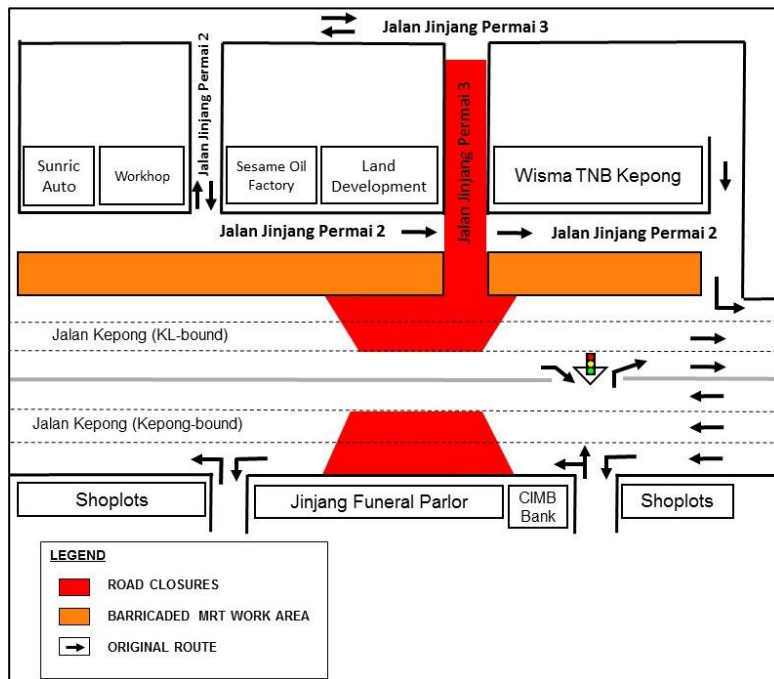

MAP 1 : NIGHT LANE CLOSURES BY STAGES ALONG JALAN JINJANG PERMAI 3 & JALAN KEPONG (KEPONG-BOUND AND KL-BOUND)

Map 2

- Jalan Kepong (Kepong-bound) - Middle and fast lane closures from Jinjang Funeral Parlor to CIMB Bank.
- Jalan Kepong (KL-bound) - Middle and fast lane closures nearby Wisma TNB Kepong.
- Jalan Jinjang Permai 3 (nearby Wisma TNB Kepong) – Internal road closure for a stretch of 180 metres by stages. During this closure, motorists can use Jalan Jinjang Permai 2 to go to Wisma TNB Kepong.

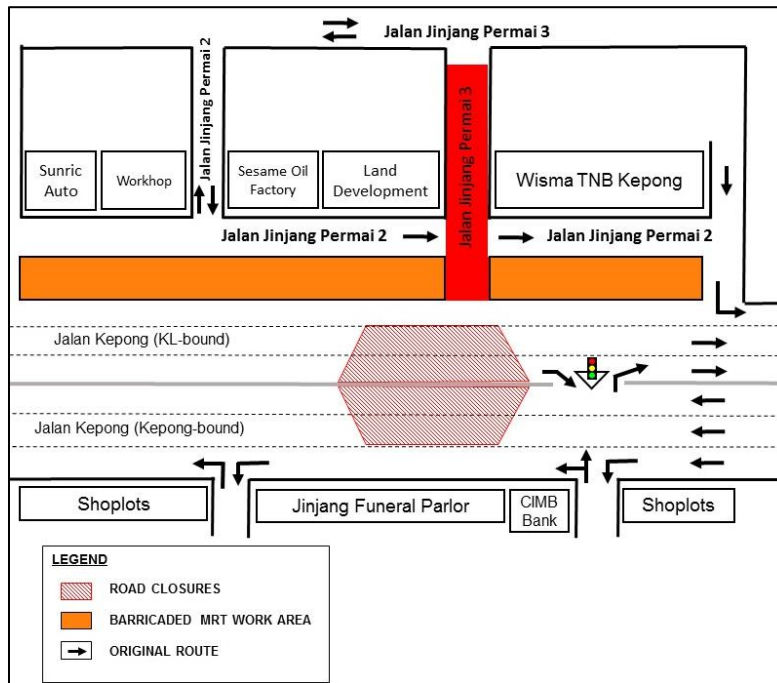

MAP 2 : NIGHT LANE CLOSURES BY STAGES ALONG JALAN JINJANG PERMAI 3 & JALAN KEPONG (KEPONG-BOUND AND KL-BOUND)

The closures will be implemented intermittently and at any one time there will be one (1) lane made available for motorists on both bounds.

2. LANE CLOSURES UNDERNEATH MRR2 FLYOVER (KEPONG-BOUND AND SELAYANG-BOUND)

Date	04 March 2017 - 24 March 2017
Time	11pm – 6am
Duration	20 days
Reason	To facilitate utilities detection and relocation for MRT construction works

There will be left lane closure towards Jalan Kepong (Kepong-bound) and Jalan Kepong Garden (Selayang-bound) below the Lebuhraya Selayang – Kepong (MRR2) starting from **4 March 2017 to 24 March 2017, 11pm – 6am (daily)**.

During the closures, one (1) lane will be available for motorist heading to Kepong-bound and Selayang-bound, respectively (as indicated in BLUE arrow in the map).

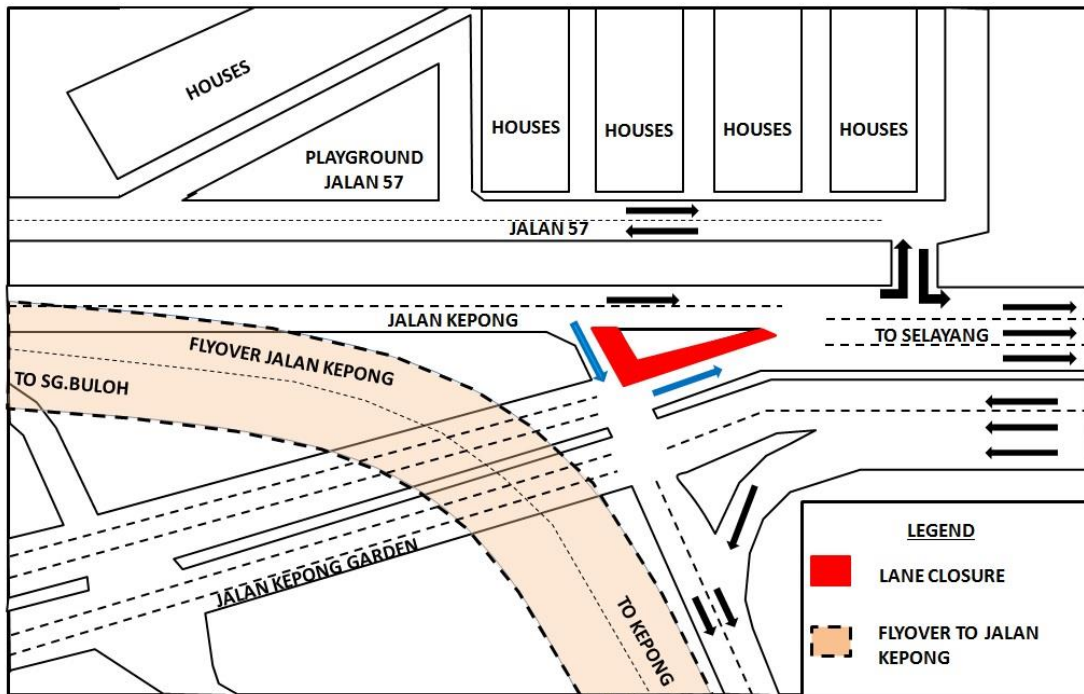

MAP 3 : LANE CLOSURES UNDERNEATH MRR2 FLYOVER (KEPONG-BOUND AND SELAYANG-BOUND)

For media enquiries, please contact:

Juliet Choong Wai Gaik (Item 1)

Tel: +6012 601 0318

julietchoong@ijm.com

Zaini Ghazali (Item 2)

Tel: +6012 328 1821

zainighazali@azrb.com

Leanne Ann Susau (Item 1-2)

Tel: +603 7493 3832

leanne@mgjv-kvmrt.com.my

MMC GAMUDA KVMRT (PDP SSP) SDN BHD (1117100-V)
 Block A, Level 17, Menara Mustapha Kamal, PJ Trade Centre
 No 8, Jalan PJU 8/8A, Bandar Damansara Perdana, 47820 Petaling Jaya
 Selangor Darul Ehsan, Malaysia
 T: +603-7494 2222 F: +603-7727 0222 www.mymrt.com.my