

TRAFFIC ANNOUNCEMENT
UPDATES ON TRAFFIC MANAGEMENT PLAN FOR MRT SSP CONSTRUCTION ALONG JALAN
JINJANG PERMAI 2, JALAN KEPONG & JALAN SULTAN AZLAN SHAH
13 JANUARY 2017

1. CONTINUATION OF SHORT-TERM NIGHT LANE CLOSURES BY STAGES ALONG JALAN JINJANG PERMAI 2 & JALAN KEPONG (SOUTH-BOUND)

Date	15 January 2017 - 31 January 2017
Time	10pm – 6am
Duration	17 days
Reason	To facilitate loading/unloading material, site clearing and tree cutting, piloting and mapping, utilities relocation, and survey works for MRT construction works.

There will be a continuation of short-term night lane closures by stages along Jalan Jinjang Permai 2 & Jalan Kepong (South-bound) from **15 January 2017 to 31 January 2017, 10pm - 6am**.

The traffic management plan involves the following closures:

Closure A: Internal road of Jalan Jinjang Permai 2 starting from Balai Bomba Jinjang to Wisma TNB Kepong.

Flagman will be in place using "STOP" and "GO" method to indicate the traffic flow.

Closure B: Left most lane closure along Jalan Kepong (South-bound) for a stretch of 180 meters.

The closures are in stages and at any one time there will be two (2) lanes made available for motorists on Jalan Kepong (South-bound).

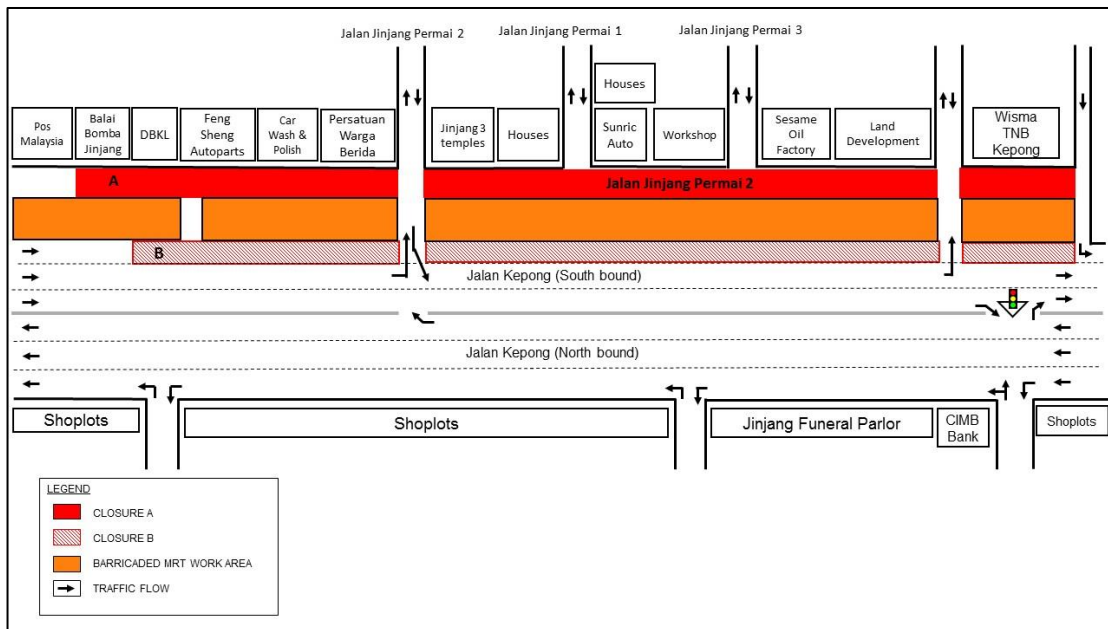

MAP 1 : CONTINUATION OF SHORT-TERM NIGHT LANE CLOSURES BY STAGES ALONG JALAN JINJANG PERMAI 2 & JALAN KEPONG (SOUTH-BOUND)

2. SHORT-TERM NIGHT LANE CLOSURES IN FRONT OF SEKOLAH MENENGAH KEBANGSAAN (P) JALAN IPOH ALONG JALAN SULTAN AZLAN SHAH (NORTH-BOUND)

Date	15 January 2017 - 31 January 2017
Time	10pm – 6am
Duration	17 days
Reason	To facilitate loading/unloading material and tree cutting for MRT construction works.

There will be a short-term night lane closures in front of Sekolah Menengah Kebangsaan (P) Jalan Ipoh along Jalan Sultan Azlan Shah (North-bound) from **15 January 2017 to 31 January 2017, 10pm - 6am intermittently**.

The traffic management plan involves the following closures:

- Closure of internal road near the bus stop of Sekolah Menengah Kebangsaan (P) Jalan Ipoh.
- Slow lane closure for a stretch of 180 metres from Mercedes-Benz until Sekolah Menengah Kebangsaan (P) Jalan Ipoh.
- Median lane closure for a stretch of 180 from Mercedes-Benz until Sekolah Menengah Kebangsaan (P) Jalan Ipoh.

The closures are in stages and there will be one (1) lane made available for motorists at any one time.

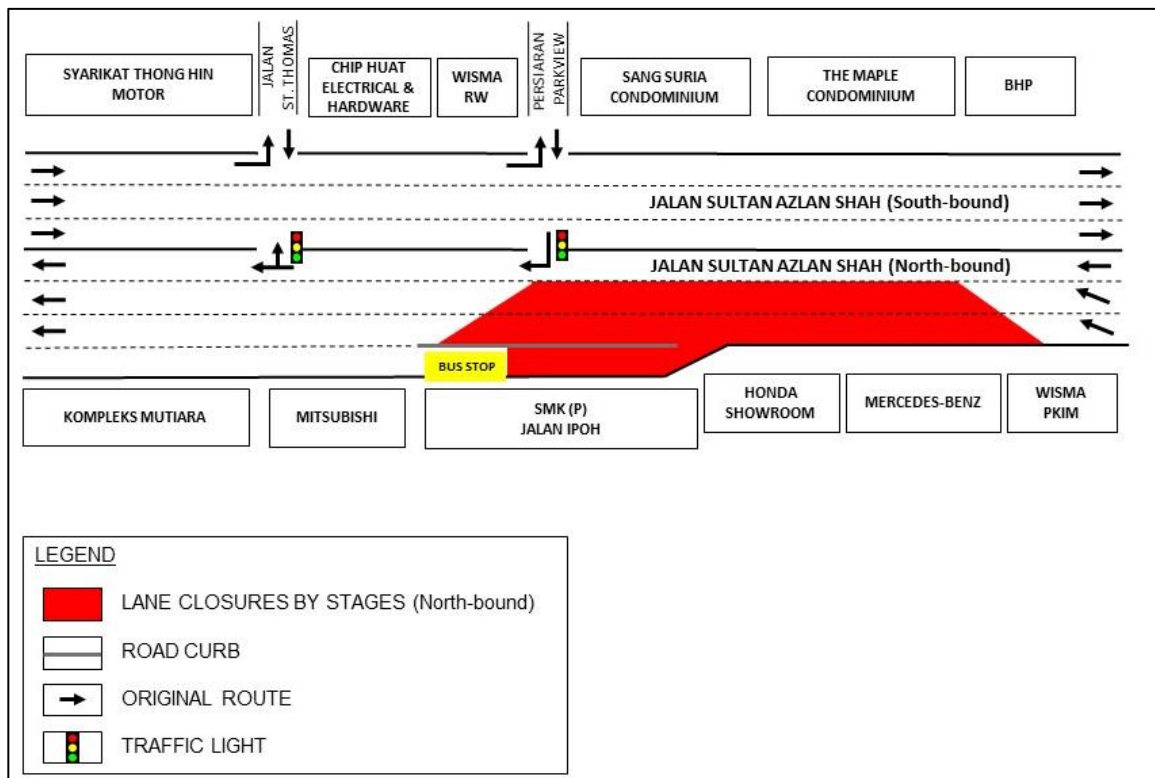

MAP 2 : CONTINUATION OF LONG-TERM LANE CLOSURES ALONG JALAN KUALA SELANGOR (SUNGAI BULOH-BOUND AND KEPONG-BOUND)

For media enquiries, please contact:

Juliet Choong Wai Gaik

Tel: +6012 601 0318

Leanne Ann Susau

Tel: +603 7493 3832

julietchoong@ijm.com

leanne@mgjv-kvmrt.com.my

MMC GAMUDA KVMRT (PDP SSP) SDN BHD (1117100-V)

Block A, Level 17, Menara Mustapha Kamal, PJ Trade Centre

No 8, Jalan PJU 8/8A, Bandar Damansara Perdana, 47820 Petaling Jaya

Selangor Darul Ehsan, Malaysia

T: +603-7494 2222 F: +603-7727 0222 www.kvmrt.com.my