

TRAFFIC ANNOUNCEMENT
UPDATES ON TRAFFIC MANAGEMENT PLAN FOR MRT SSP CONSTRUCTION ALONG JALAN KUALA
SELANGOR AND JALAN KEPONG
27 DECEMBER 2016

1. CONTINUATION OF LANE CLOSURES ALONG JALAN KUALA SELANGOR (SUNGAI BULOH-BOUND AND KEPONG-BOUND)

Date	29 December 2016 - 22 January 2017
Time	24 hours
Duration	1 month
Reason	To facilitate loading/unloading material and open guard rail, site clearing and tree cutting, mapping and piloting, utilities relocation, temporary works - sheet pile and earth work, soil investigation, road widening and diversion, piling and pile cap

To facilitate our construction works, there will be a continuation of lane closures along Jalan Kuala Selangor (Sungai Buloh-bound) from **29 December 2016 to 22 January 2017, 24 hours daily**.

The traffic management plan involves the following closures:

Closure A (29 December 2016 - 22 January 2017):

- i. Left-most lane closure along Jalan Kuala Selangor (Sungai Buloh-bound) at KM47 before the ramp up to Sierramas.
- ii. Left-most lane closure along Jalan Kuala Selangor (Sungai Buloh-bound) after the ramp up to Sierramas for a stretch 100 metres; Left lane closure on the ramp up to Sierramas for a stretch 100 metres
- iii. Left lane closure towards Sungai Buloh toll for a stretch of 100 metres.
- iv. Left lane closure on the ramp up to Sierramas and IGB International School (Kepong-bound) for a stretch of 100 metres.

Closure B (15 January 2017 - 22 January 2017):

Right lane closure towards Sungai Buloh toll for a stretch of 100 metres. During this closure, Closure A(iii) will not take place.

LEGEND:

- Closure A
- Closure B
- Original route

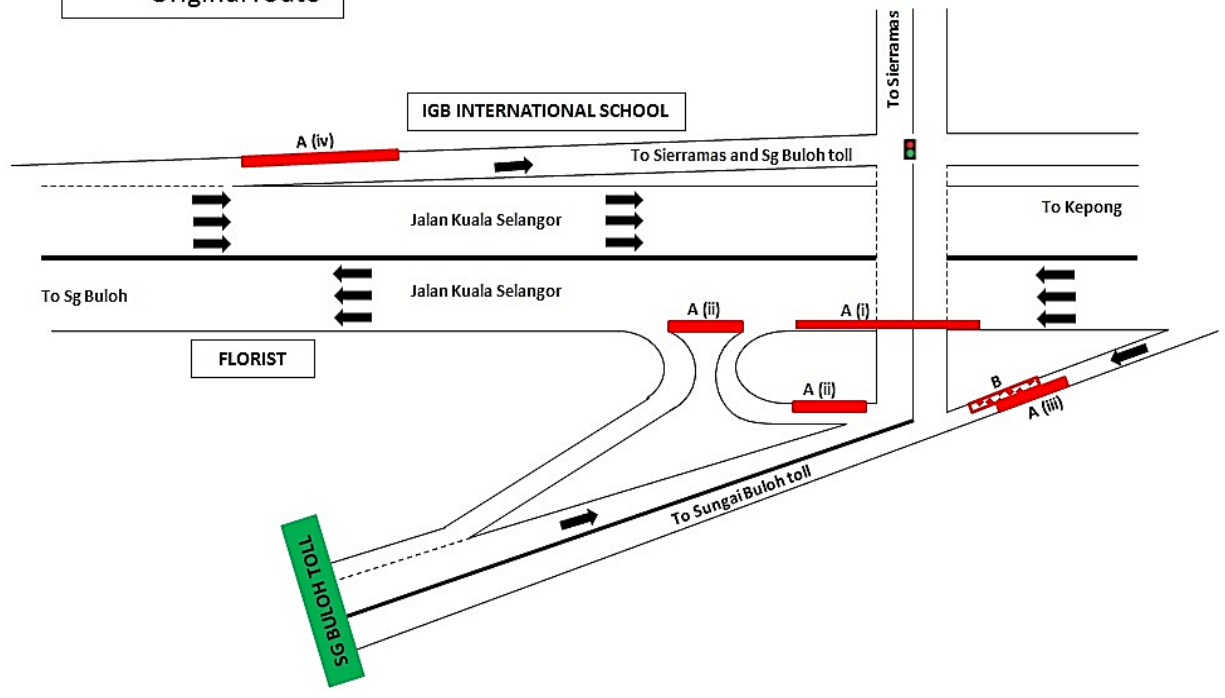

MAP 1 : CONTINUATION OF LANE CLOSURES ALONG JALAN KUALA SELANGOR (SUNGAI BULOH AND KEPONG-BOUND)

2. MEDIUM-TERM LANE CLOSURES ALONG JALAN KEPONG (JINJANG-BOUND)

Date	29 December 2016 - 21 January 2017
Time	11pm-6am
Duration	25 days
Reason	To facilitate relocation of utility for MRT construction works

There will be medium-term lane closures along Jalan Kepong (Jinjang-bound) at Jinjang Utara area starting from **29 December 2016 onwards, 11pm until 6am daily, intermittently.**

The traffic management plan involves the following closures:

Closure A (29 December 2016 - 9 January 2017):

Left-most lane closure along Jalan Kepong (Jinjang-bound) after the junction of Jalan Jinjang Utama for a stretch of 100 metres.

Closure B (10 January 2017 - 21 January 2017):

Left-most lane closure along Jalan Kepong (Jinjang-bound) towards Ipoh Road Hakka Yong Tau Fu Restaurant for a stretch of 200 metres.

The closures are exercised intermittently and at any one time there will be two (2) lanes made available for motorists.

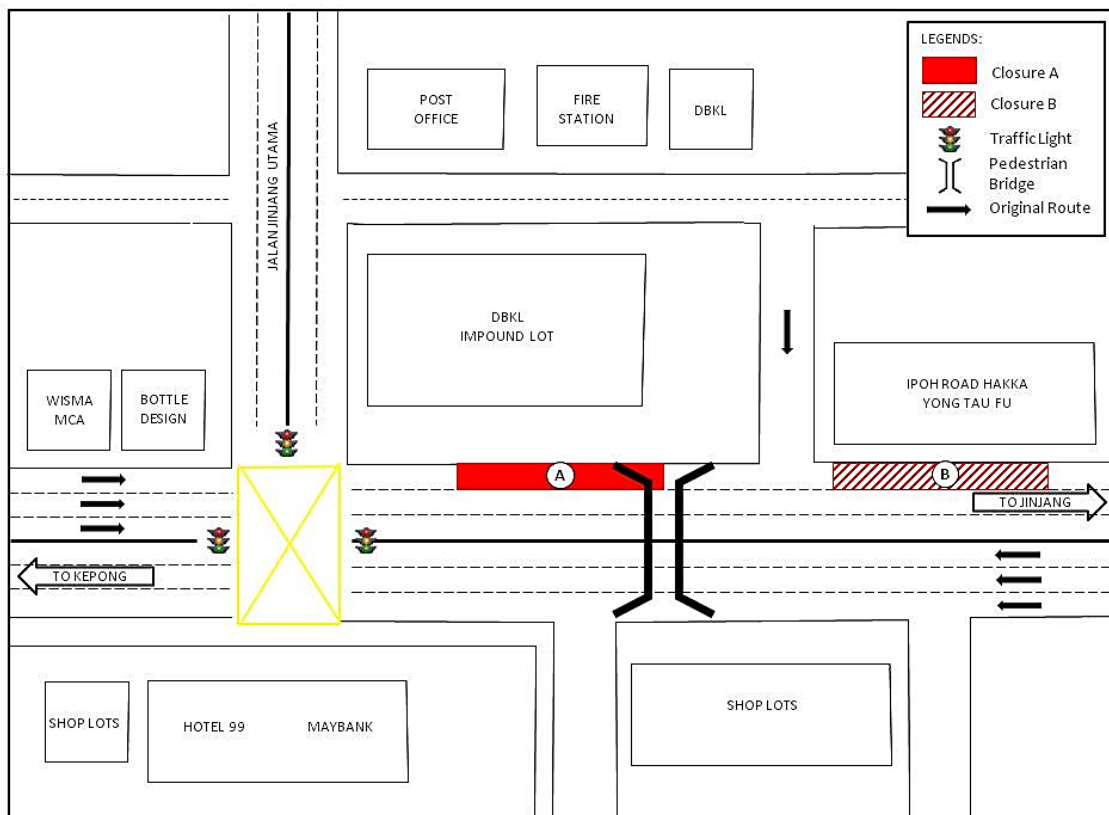

MAP 2 : MEDIUM-TERM LANE CLOSURES ALONG JALAN KEPONG (JINJANG-BOUND)

3. MEDIUM-TERM LANE CLOSURES ALONG JALAN KEPONG (SUNGAI BULOH-BOUND AND JINJANG-BOUND)

Date	29 December 2016 - 27 January 2017
Time	11pm-6am
Duration	30 days
Reason	To facilitate utility detection work along Jalan Kepong for MRT construction works

There will be medium-term closures along Jalan Kepong (Sungai Buloh-bound and Jinjang-bound) from Pekan Lama Kepong until Metro Perdana Barat area starting from **29 December 2016 onwards, 11pm until 6am daily, intermittently.**

The traffic management plan involves the following closures:

Closure A (29 December 2016 - 7 January 2017):

Right-most lane closure along Jalan Kepong (Jinjang-bound and Sungai Buloh-bound) from Balai Polis Kepong until the junction of Aeon Metro Prima for a stretch of 600 metres.

Closure B (8 January 2017 - 17 January 2017):

Left-most lane closure along Jalan Kepong (Jinjang-bound) from the junction of Jalan Metro Perdana Barat 14 until Jalan Metro Perdana Barat 4 for a stretch of 100 metres.

Closure C (18 January 2017 - 27 January 2017):

Right-most lane closure along Jalan Kepong (Jinjang-bound and Sungai Buloh-bound) from the junction of Aeon Metro Prima until junction of Jalan Metro Perdana Barat for a stretch of 200 metres.

The closures are exercised intermittently and at any one time there will be one (1) lane made available for motorists at both-bounds.

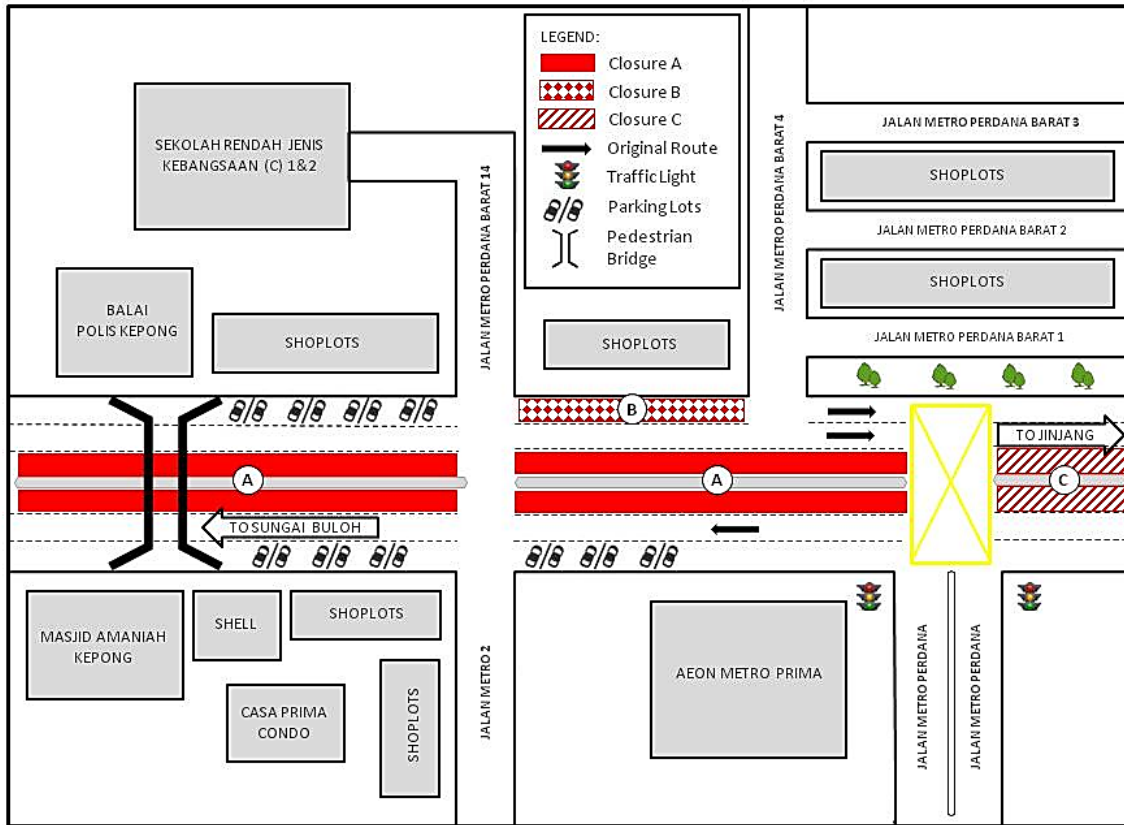

MAP 3 : MEDIUM-TERM LANE CLOSURES ALONG JALAN KEPONG (SUNGAI BULOH-BOUND AND JINJANG-BOUND)

For media enquiries, please contact:

Mohd Sofie Hassan (Item 1)

Mohd Farid Sumali (Item 2 - 3)

Leanne Ann Susau (Item 1 - 3)

Tel: +6019 228 3004

Tel: +6017 227 7357

Tel: +603 7493 3832

sofie@sunway.com.my

mohdfarid@azrb.com

leanne@mgiv-kvmrt.com.my

MMC GAMUDA KVMRT (PDP SSP) SDN BHD (1117100-V)

Block A, Level 17, Menara Mustapha Kamal, PJ Trade Centre

No 8, Jalan PJU 8/8A, Bandar Damansara Perdana, 47820 Petaling Jaya

Selangor Darul Ehsan, Malaysia

T: +603-7494 2222 F: +603-7727 0222 www.kvmrt.com.my